

~~GOODHOPE TWP 13 R 18~~

~~LAUREL TWP 12 R 18~~

Copco #1

— COLLEGE —

NOTE

BOOK

LAUREL ATTACHED TO FALLS

SEC = 1 CHECKED

Blackstone, Ralph. w
 RISH, EDWARD W. & CORA M. ^{PO} NENW PT ✓ 20 A ✓ Vol-42-P-528

" " " " " ^{PO} " " " ✓ 21 A ✓ Vol-49 P-560

" MARGRET A ^{PO} S/2NW & NWNW ✓ 126 A ✓ Vol-70-P-22

~~LEWIS, ALBERT~~ ^{PO} LOT 1 ✓ 8 A ✓ Vol-43-P-411

SATER EVERETT
~~RINGHISER JANE~~ ^{PO} LOT 2 ✓ ^{135.5} ~~152 A~~ ✓ Vol-⁹⁷⁻⁶⁰¹ ~~70~~ P-106

RINGHISER EVA, MAY ^{PO} E/2 SW ✓ 83 A ✓ Vol-75-P-203

COX JOHN
 COX, CLARENCE J. & HAZEL M. ^{PO} LOT 2 ✓ 5 A ✓ Vol-105-422
 Vol-74-P-531

~~SHAW, EMMA J~~ ^{PO} NWSW ✓ 40 A ✓ Vol-91-116-376

SATER J.F. ^{PO} SWSW ✓ 41 A ✓ Vol-47-P-368

~~NIHIZER, SAMUEL~~ ^{ELLA} NE/4 PT ✓ 82 A ✓ Vol-¹⁰³⁻²⁷⁴ ~~55~~ P-197

CARPENTER, CLAUDE NE/4 PT ✓ 74 A ✓ Vol-60 P-233

CRAWFORD ^{HAROLD} ~~LORA~~ ^{PO} NE/4 PT ✓ 8 A ✓ Vol-⁹⁷⁻³⁶² ~~91~~ P-648

DISBENNET HARRY LOT-2 PT 16.6. 86-653

ST JOHN BY LUTH CH Vol-17-P-274 & Vol-17-353

LAUREL = ATTACHED TO FALLS

SEC = 13

~~E.H. DELONG~~
~~KRINN WILBERT F.~~ W 1/2 NW

✓ 84 PO

97-224
VOL 41 P 228

SEC = 14

~~FREY E~~
~~KRINN WILBERT F~~ NENE ✓

✓ 42 PO

98-641
VOL 41 P 228

11 12 11 SE NE

✓ 40 PO

98-
VOL 41 P 228

LAUREL = ATTACHED TO GOOD HOPE

SEC = 2

EDWARDS FRANK
DRAKE, GEORGE E. & MARY M. NW 1/4

✓ 163.28

95-562
VOL 75 P 413

BROWN, WILLIAM & MARTHA PT-NW 1/4

✓ .50

VOL 81 P-42

SEC = 2 CHECKED

95-562

EDWARDS FRANK PT SW 1/2 ✓ 150.20 Vol 84 P 170
~~166 Vol 80 P 77~~

LINN VIRGIL
BLAIR PEARL

15.8 Vol 93-325
3.89 Vol-101-73

PT NW 1/4
SEC = 3

Goss RALPH
KLINE DANIEL ETAL PO W 1/2 NW ✓ 84 Vol 62 P 170
~~104-675
103-466
P~~

CARPENTER
CARPENTER CARL PO E 1/2 NW & NESW & NW NEPT ✓ 166 Vol 59 P 480
~~101-446
82-244~~

EDWARDS FRANK PO W 1/2 SW ✓ 80.18 Vol 59 P 420

EDWARDS FRANK
IRAKE GEORGE & MARY M PO PT NW NE & NE NEPT ✓ 40 Vol 75 P 773
95-562

WACHTEL CARL & PEARL PO PT S 1/2 NE & PT N 1/2 SE ✓ 35 " " " "

PITTMAN, BERTHA GRACE PO ✓ 73 Vol 86 P 489
98-474
Vol 67 P 355

EDWARDS FRANK PO SE SW ✓ 42 Vol 50 P 299
91-303

MYERS, JOHN & HOWARD PO S 1/2 SE ✓ 84 Vol 49 P 428

PO NE SE ✓ 60 Vol 32-135

W. MARSHALL ETAL
G. H. MARSHALL & HOWARD PO NE 1/4 PT ✓ 3.50 Vol 87 P 333

JAMES LAUDY
MYER PO PT NE 1/4 ✓ .50 Vol 74 P 222

HEWITT PO W 1/2 SW 1/4 PT ✓ 3.82 Vol 74 P 93

LASICK JOHN 9.6 Vol-102-389

SEC = 2 CHECKED

95-562

EDWARDS FRANK PT SW 1/2 ✓ 150.20 Vol 84 P 170
~~166 Vol 80 P 77~~

LINN VIRGIL
BLAIR PEARL

15.8 Vol 93-325
3.89 Vol-101-73

PT NW 1/4
SEC = 3

Goss RALPH
KLINE DANIEL ETAL PO W 1/2 NW ✓ 84 Vol 62 P 170
~~104-675
103-466
P~~

CARPENTER
CARPENTER CARL PO E 1/2 NW & NESW & NW NEPT ✓ 166 Vol 59 P 480
~~101-446
82-244~~

EDWARDS FRANK PO W 1/2 SW ✓ 80.18 Vol 59 P 420

EDWARDS FRANK
IRAKE GEORGE & MARY M PO PT NW NE & NE NEPT ✓ 40 Vol 75 P 773
95-562

WACHTEL CARL & PEARL PO PT S 1/2 NE & PT N 1/2 SE ✓ 35 " " " "

PITTMAN, BERTHA GRACE PO ✓ 73 Vol 86 P 489
98-474
Vol 67 P 355

EDWARDS FRANK PO SE SW ✓ 42 Vol 50 P 299
91-303

MYERS, JOHN & HOWARD PO S 1/2 SE ✓ 84 Vol 49 P 428

NESE PO ✓ 60 Vol 32-135

MARSHALL ETAL
Gottschalk Howard PO NE 1/4 PT ✓ 3.50 Vol 87 P 333

James Landry
MYER PO PT NE 1/4 ✓ .50 Vol 74 P 222

HEWITT PO W 1/2 SW 1/4 PT ✓ 3.82 Vol 74 P 93

LASICK JOHN 9.6 Vol-102-389



SEC = 4

STATE OF OHIO	PO	LOT 2-5 PTS ✓	1.85 ✓	VOL 65	536 537
MYERS,	MELVIN CHAS	LOT 2-5 PTS ✓	30 ✓	101-272 VOL 61-P 372	
"	"	LOT 5 PT ✓	60 ✓	61-37211	
EDWARDS, FRANK		LOT 5 PT ✓	85 ✓	VOL 76 P 572	
"	GEO	LOT 5 PT	3.82	VOL 100-358	
"	"	LOT 1 ✓	50 ✓	VOL 72 P 76	
SILER HAROLD		PT LOT 1	.89	VOL 100-262	
GROSS RALPH 104-675		LOT 5 PT NENE ✓	1.04 ✓	102-486 VOL 67 P 170	
KLINE, DANIEL ETAL					
STATE OF OHIO	PO	LOT 3 cm wooly check	69 ✓	VOL 63 P 591	
"	"	LOT 11 SWAMP	40 ✓	VOL 73 P 66	
ELICK ESTHER	PO	LOT 4 ✓	58 ✓	94 304 VOL 25 P 244	

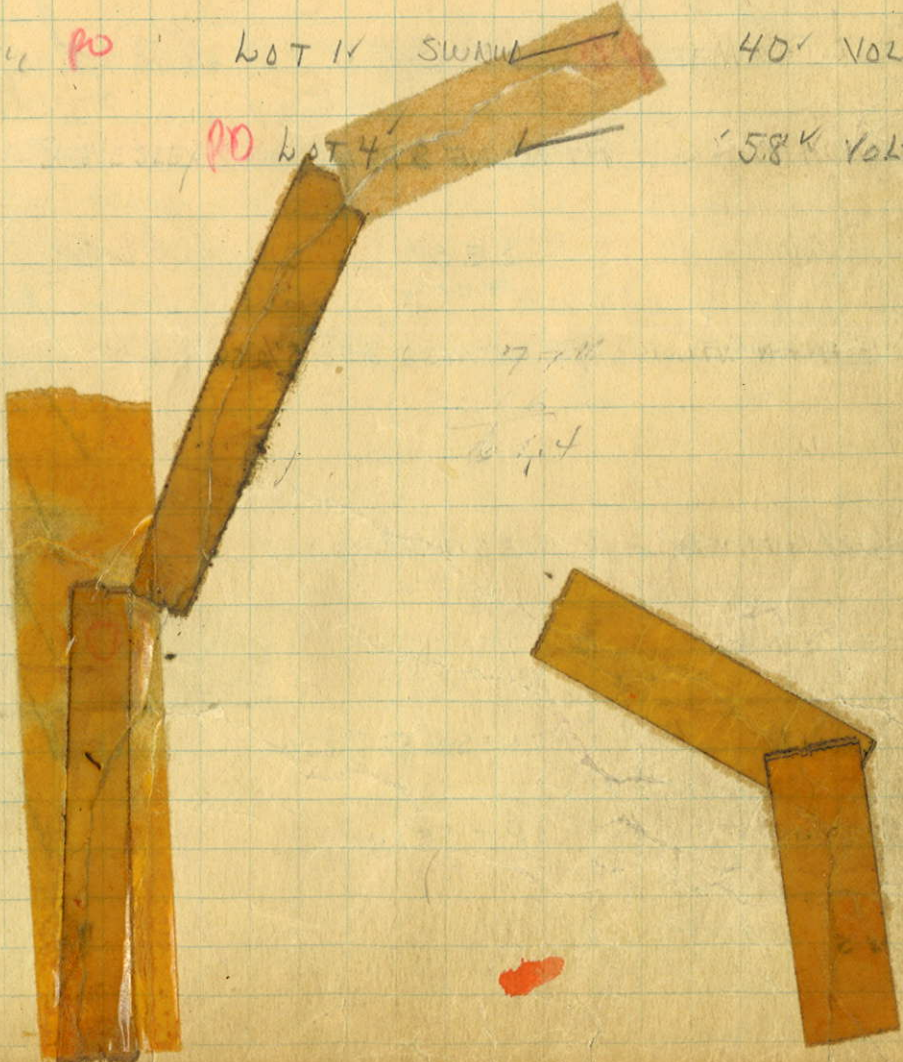

SEC = 5

ROTENNING KARL

PT W 1/2 NE & NENE

VORHEES JESSE

LOTS 1-4 PT

PO

30 ✓ Vol-

87 ✓ Vol 84 P 578

" "

" "

PT W 1/2 NE & PT NENE

53 ✓

Vol 41

VORHEES JESSE

1/2 NW 1/4 E

LOTS 2-3-4 PT

PO

50 ✓

Vol 72 P 9

Beougher, W.M.

ANSPAUGH, EVA

PO X

" " " 4 SWNW

80 ✓

Vol 85 P 395

EDWARDS, FRANK

W 1/2 SE PT

PO

25 ✓

Vol 48 P 525

" "

" "

" " "

PO

60 ✓

Vol 53 P 635

" "

" "

E 1/2 SE PT

PO

11 ✓

Vol 72 P 456

GED. F. & WIFE

PO

" " "

PO

74 ✓

Vol 60 P 208

STATE OF OHIO

PT W 1/2 NE & PT NENE

PO

77 ✓

Vol 63 P 591

ANDERSON CARL

SE SE

PT SW 1/4

PO

94 ✓

Vol 63 P 591

ANDERSON ROSS

Vol 99-272

SCOTT FLORENCE

PT N E SW SE & PT S 1/2 SW

PO

39.88

91-474
Vol 81 438

" "

" "

" "

" "

PO

30.12

Vol 11

AGEE KENNETH

Ficker, William

PT N E SW PT S 1/2 SW

PO

5.88

91.520
Vol 87 P 128

LIPTON E. G.

PO

50

Vol 86 P 59

" "

" "

PT N E SW PT S 1/2 SW

PO

42

" " "

" "

" "

PT SE SW

PO

10

" " "

WILKINS ARTHUR

Rotening

Karl

PO

12

Vol 83-58

Edley

Edley

34

100-658
Vol 27-197

SEC = 6

146

SEC = 5

146

Sec 5

Varhus, Jose lots 1-4 PT 87 ✓ Vol 84 P 578
 " " " 2-3-4 PT 50 ✓
 " " " Pt W 1/2 NE + Pt NENE 9 ✓

Brougher, W.M. lots 2-3-4 - Pts SWNW 80 ✓ Vol 85 - 345

Edwards Frank W 1/2 SE PT 25 ✓
 " " " " 60 ✓
 " " " E 1/2 SE PT 11 ✓
 " Geo. F. E 1/2 SE PT 74 ✓

State of Ohio Pt W 1/2 NE + Pt NENE 77 ✓
 " " SESE 44 ✓

Wilkins Arthur D + Wilma Pt W 1/2 NE + Pt NENE 12 ✓
 Immel, John + Sylvia " " " " 7 ✓ Vol 82 P 489
 Scott Florence Same as below 30.12 ✓
 Scott Florence Pt NESW + Pt S 1/2 SW 39.88 ✓
 Sater, P. R. + W. H. " " 5.88 ✓ Vol

Hart, Marshal + Geraldine Pt DE SW + S 1/2 SW 42. ✓
 " " " " .50 ✓
 " " Pt SE SW 10 ✓

Yates Geo W 1/2 NE & NENE 26 ✓

SEC = 6

WELKER FLORA

W 1/2 SWPT PO

95-380
75.50 Vol 81-352

DAVIS, LEVI JR

SWNW PO

42 ✓ Vol 66-P150

WELKER ~~FLORA~~
Loy E

NWNE & SWNW & NE SW PO

122 ✓ Vol 71 P 31
93-383

" " "

W 1/2 SWPT PO

4.50 ✓ Vol 71 P=31

" " "

LOT 2 NWNE & SWNE

114 ✓ Vol 71-P 29

NE & NW 40 NW KW Except 20A of W Side

" " "

SE SW & S 1/4 SE & NWNW & NENW

60 PO ✓ Vol 72 P-28
102-173

BIGHAM MATILDA

W 1/2 NW PT

20 ✓ Vol-65-P-354

VORHEES JESSE

URBAN CLARENCE & ZELIA

NENE

42 ✓ Vol 83 P 355
99-467

KOHLER HARRY

BURDGE, ADELAIDE R.

PTS SESW & S 1/2 SE & NWNW & NENW

141.50 ✓ Vol 64 P 121
94-203

Smyers, Howard

SENE

42 ✓ Vol 87 P 429

SWSE 40 SE SW 3967 E 1/2 SE 7931 Except 30A of N End of lot tract
and excepting school lot

EVERSOLE VIRGIL

PT SWNW

11.17 ✓ Vol-95-48

SEC=7

WELKER FLORA

LOT 2 ✓

✓ 1 ✓ VOL 81 P 352

WILLIAM BLESSING

WILLIAMS, VINNIE ^{to} _{PO}

LOT 1 ✓

44 ✓

¹⁰¹⁻⁹⁴
VOL 81 P 536

SEESHOLTZ, LULU ^G _{PO}

S 1/2 SEPT ✓

16 ✓ VOL 32 P 464

" " " "

" " " "

67 ✓ VOL 63 P 154

" " DANIEL ^P

N 1/2 SE ✓

84 ✓ VOL 44 P 276

WILLIAMS THURMAN "

NESW & SENW ✓

⁹⁰⁻¹⁰
189.94 VOL 73 P 513

" " "

PTS S 1/2 SEPT

BOUGHT FROM LULU SEESHOLTZ 1938

CANT FIND

FLOWERS GOLDIE

WILSON, STANLEY

E 1/2 NE & N 1/2 NWNE ✓

¹⁰⁵⁻²⁸⁰
104.21 ✓ VOL 73 330

" " "

S 1/2 NWNE & SWNE ✓

61.74 ✓ VOL 73 330

FOSLER, FLORA ^{PO}

✓

.79 ✓ VOL 61 546

" " ^{PO}

✓

1.26 ✓ VOL " " "

LAVERNA WOLFE

KUCKLE RICHARD

PT N 1/2 NW

36

¹⁰⁶⁻⁷¹
VOL 94 P 432

WILLIAMS RONAL

PT SE NW

8.49

VOL 102-430

HUFFINES J.W

" " "

13

VOL 102-431

MOUND CROSSING - S. T.

R. 18 = T. 12

SEC = 7

CANFIELD ARCH S 1/2 SW 84 A ✓ Vol 77 - P = 295

MARTLEY RICHARD SW NW - NWSW 84 A ✓ Vol - 94 P - 18

SEC = 17

REISER WILLIAM
~~WOLTZ NAOMI~~ S 1/2 NW PO 82 A ✓ Vol ⁹⁹⁻²³⁰ ~~89-479~~ P 161

COOK JAMES NW SW PO 41 A ✓ Vol - 95 - 72

WIDMAIER LILLIAN
~~FETHEROLF, HARVEY & WIFE~~ E 1/2 SW PO 80 A ✓ Vol ¹⁰¹⁻¹² ~~61~~ P 174

BAKER WOOD PRESERVING CO.
~~RICHMOND, LEVI, C~~ SW SW PO 41 A ✓ Vol ⁹⁶⁻⁴²⁵ ~~47~~ - P 221

SEC = 8

✓ STAHR LEWIS	LOT 4 SW 1/4	PO	✓ 171	✓ VOL-43-P 522
✓ STAHR MADA	BLD ON LEASED LAND	PO	✓ 20	✓ VOL-66-391
✓ EFFIE & WILLIAM				Vol-99-230
✓ WOLFE NAOMI	LOT 5	PO	✓ .50	✓ Vol 34 P 161
✓ EDWARDS GEO. F. & WIFE	NENE PT	PO	✓ 37	✓ VOL 60 P 208
✓ [redacted] Geo F	LOT 3	PO	✓ 14	✓ Vol-46-P-462
✓ [redacted]	LOT 1	PO	✓ 86	✓ Vol-46-P-462
✓ [redacted] Geo F	LOT 2	PO	✓ 31	✓ Vol-48-525
✓ HANSEN, EARL W. MCKI	NENE PT	PO	✓ 5	✓ Vol 70 P 305
✓ [redacted]	E 1/2 SE & SENE	PO	✓ 129	✓ Vol 70 P-305
✓ [redacted]	SWNE	PO	✓ 41	✓ Vol 70 P 303
✓ M ^{rs} COY OLETA				105-281
✓ WILSON, STANLEY & WIFE	W 1/2 NW	PO	✓ 86	✓ Vol 57 P 443
✓ STUMP GLADY ET-AL				105-504
✓ BINGHAM R.O.				Vol 94-130
✓ M ^{rs} KITTRICK DOROTHY	W 1/2 SE	PO	✓ 25	
✓ TRISKA JOHN				
✓ STIMMEL PAUL	PT W 1/2 SE	PO	✓ (3)	Vol
✓ RICKETTS VIRGIL				98-225
✓ WOOD NORMAN	150x250'		1.75	Vol-98-524
✓ TUCKER O. J.			3	97-112 Vol-94-557
✓ TRISK H JOHN J.	PT W 1/2 SE		50	98-149 Vol-95-145

SEC = 9

✓ HANSEN, EARL W. MCK. lots-2-5-6 ✓ P 90.50 Vol 70 P 305

✓ Huffines, EMERY - E side Knicker Rd ✓ (10) P 10 Vol-70-340

✓ Huffines, Emory W 1/2 SE. ✓ 179 ✓ Vol-61-P-36

✓ STATE OF OHIO lots-1-3-4 P 114 ✓ Vol 65 P 536

✓ " " " " LOT 9 SENW ALL N. OF RD. 240 ✓ 30 P 30 Vol 72 P 512

✓ NIXON J. J. ✓ 95-119 ✓ Vol 79-362

✓ McMAHON MURRAY M. & CHARLOTTE B. LOT 11 ✓ P 5 ✓ Vol 79-362

✓ ~~STIVERSON, ELWOOD & EDITH~~ ✓ P 9 ✓ Vol-55-P-330

✓ " " " " SENW ✓ P 58 ✓ Vol 46 P 345

✓ FOUCH, C. E. HOWARD S PT. LOT 12 ✓ P 78.9 ✓ Vol-100-588 ✓ Vol-94-221

✓ MYERS, CHAS. N 1/2 NE ✓ P 94 ✓ Vol-61-P-372

✓ SCHMITT HENRY NELSON SAGER PT NE 1/4 ✓ P 20 ✓ Vol 72 P 585

✓ FAVILES R. W.

M. E. CHURCH Vol-D, P. 183

SEC=10

Hooper Margaret
✓ ~~BATLEY~~ SAMUEL F. PO

LOT 4

✓ 1.28 Vol 61 288
99-472

✓ EDWARDS FRANK PO

11 3

✓ 1.75 Vol 50 P 199
97-303

✓ BAILEY SAMUEL 11

PT SE 1/4

✓ 93 Vol 82 P 53

✓ 11 11 PO

11 11

✓ 86 11 11 11

✓ 11 11 11

NESW S. END

✓ 23 Vol 67 P 288

✓ 11 11 & WIFE

NESW N. END

✓ 20 Vol 63-343

✓ MYER, HOWARD & JOHN PO

LOT 5

✓ 47 Vol 49 P 428

KELCH BROS

WORKING INT

✓ WHITCRAFT LESTER PO

SE SW

✓ 44 Vol 92-49

✓ STELAIER HARRY & MARY PO

LOT 2 PT

✓ 1.50 Vol 82-283

KREIDER CHAS

✓ 11 11 PO

11 2 11

✓ 60 11 11 11

HULL V.V.

SHAW LOGAN

✓ ~~MORRIS, FLETCHER H. & PHILLIPS, NEWMAN~~ W/2 SW PO

✓ 80 Vol 82-59

100-184
95-395

✓ LASICK JOHN

~~CARPENTER CARL~~

LOT 1

✓ 3.82 Vol 59 P 420
102-389

✓ HENGST, C. L. PO

LOT 1 PT

✓ 1.18 Vol 74 P 93

✓ GREEN MARY ETAL

LOT 2 PT

✓ 28.50 Vol 55 P 181
94-629

W/2 SW 1/4 LAND

1.25

101-414
Vol 86 P 281

✓ BAILEY CARL PO

50

Vol 93-146

HOOPER MARG.

LOT 1 PT

1.21

Vol 99

VAN IRRE

DEC 211

BERRY GUY

ROBERT NENW

✓ 42A

VOL 30

VAN FOSSEN J.H.
WILLIAMS V.L. ETAL

SIFER VIRGIL D ET M.

SENW

✓ 40A

104-689

~~101-144~~

VOL 47

|| || ||

SW 1/4

✓ 166A

~~87-391~~

VOL 47-P 3

W 1/2 NW

✓ 84A

VOL 33-P

BALEY, SAMUEL F.

LAUREL ATTACHED TO FALLS

SEC = 11

104-689
104-144

87-391

VAN FOSSEN J.H.
WILLIAMS V.L. ETAL

~~SATER VIRGIL~~

LOT 1

✓ 22

VOL 38 P-119

SATER VIRGIL F.

SESE

✓ 41

VOL 41 P-228

WILLIAMS V.L. ETAL

LOT 2 - NW. SE & PTSWNE

101

VOL 101-144

SATER EVERETT M. W/2 SE & PTSWNE

✓ 126 PO

VOL 47 P 368

11

11

11 E/2 LOT 2

✓ 142 PO

11 11 11

SEC = 12

HIGHLY SARAH

S/2 SW

✓ 84 PO

VOL 6 P-253

WOODROW JOHN M.

~~GREEN GILBERT F.~~

PTN/2 SE & E/2 SW PT

✓ 89 PO

VOL 84 P 444

~~VOL 63 P-305~~

WOODROW JOHN M.

FRY E.

KRINN WILBERT F.

W/2 SW

✓ 84 PO

98-611
VOL 41 P 228

KRINN W.F.

N/2 NW

✓ 84 ✓

VOL 50 P 500

KORN MILLER, HOMER & OLIVE

LOT 1 PT LOT 2 PT

✓ 147.75 PO

VOL 77 P 311

LENZ ALBERT

LOTS 1-2 PTS PO

✓ 62.25 PO

VOL 43 P-411

MITCHELL W.D.

MITZNER, SAMUEL, F.

SESE

✓ 42 PO

99-111
VOL 43 P-416

SATER EVERETT M.

PTN/2 NW

✓ .50 PO

VOL 50 P-543

LAUREL ATTACHED TO FALLS

SEC = 11

104-689
101-144

87-391

VAN FOSSEN J.H.
WILLIAMS V.L. ETAL

~~SATER VIRGIL~~

LOT 1

✓ 22

VOL 38 P-119

SATER VIRGIL F.

SESE

✓ 41

VOL 41 P-228

WILLIAMS V.L. ETAL

LOT 2 - NW. SE & PTSWNE

101

VOL 101-144

SATER EVERETT M. W/2 SE & PTSWNE

✓ 126 PO

VOL 47 P 368

11

11

11 E/2 LOT 2

✓ 142 PO

11 11 11

SEC = 12

HIGHLY SARAH

S/2 SW

✓ 84 PO

VOL 6 P-253

WOODROW JOHN M.

~~GREEN GILBERT F.~~

PTN/2 SE & E/2 SW PT

✓ 89 PO

VOL 84 P 444

~~VOL 63 P-305~~

WOODROW JOHN M.

FRY E.

KRINN WILBERT F.

W/2 SW

✓ 84 PO

98-611
VOL 41 P 228

KRINN W.F.

N/2 NW

✓ 84

VOL 50 P 500

KORN MILLER, HOMER & OLIVE

LOT 1 PT LOT 2 PT

✓ 147.75 PO

VOL 77 P 311

LENZ ALBERT

LOTS 1-2 PTS PO

✓ 62.25 PO

VOL 43 P-411

MITCHELL W.D.

MITZNER, SAMUEL, F.

SESE

✓ 42 PO

99-111
VOL 43 P-416

SATER EVERETT M.

PTN/2 NW

✓ .50 PO

VOL 50 P-543

S 1/2 NE ✓ PO ⁻⁹⁸ 84 A

NENE ✓ PO 7 A

PTNENE ✓ PO 35 A

E 1/2 SE ✓ PO 84 A

W 1/2 NE ✓ PO 84 A

S 1/2 SW ✓ PO 83.15 A

W 1/2 SW ✓ PO 89 A

✓ W 1/2 NW & SENE ✓ PO 114 A

N 1/2 NW 1/4 ✓ PO 2.08 A

N 1/2 NW 1/4 ✓ PO 9.92 A

MITCHELL WM ✓
DUNKINS C.S. ✓
HENRY

SHULL, CORA ✓

GOOCH C.K. ✓
AMPRELL HOMER ✓

WHETSTONE CORP ✓
STEWART EDWARD ✓
WIRTH, CARRIE J. ✓

IRELL NELSON ✓

THIZER, JACOB ✓

ROW JOHN M. ✓

ROW JOHN M. ✓

97-
Vol-94-1

VOL 76

~~100-239-199~~
~~VOL 58~~

VOL 74

Vol-94-14

VOL 29 P 10

VOL 58 P=41

VOL 78-416

VOL 82 PP 45

17/26 A

80
35
115

850
55
435

LAUREL = ATTACHED TO FALLS

SEC = 13

~~E.H. DELONG~~
~~KRINN WILBERT F.~~ W 1/2 NW

✓ 84 PO

97-224
VOL 41 P 228

SEC = 14

~~FREY E~~
~~KRINN WILBERT F~~ NENE ✓

✓ 42 PO

98-641
VOL 41 P 228

11 12 11 SE NE

✓ 40 PO

98-
VOL 41 P 228

LAUREL = ATTACHED TO GOOD HOPE

SEC = 2

EDWARDS FRANK
DRAKE, GEORGE E. & MARY M. NW 1/4

✓ 163.28

95-562
VOL 75 P 413

BROWN, WILLIAM & MARTHA PT-NW 1/4

✓ .50

VOL 81 P-42

SEC = 14

ROSE, W^M. L.

SE SE ✓

PO ✓ 41 A ✓ Vol-64

LUTZ ROBT & IDA

W $\frac{1}{2}$ SW ✓

82 A PO ✓ Vol-82 P

WOLFE, H. S. Etal

NW $\frac{1}{4}$ PT. ✓

PO ✓ 5 A ✓ Vol 72

WOLFE WAYNE

HILLIARD, BESSIE

NW $\frac{1}{4}$ PT ✓

PO ✓ 93 ✓ 99-460
~~128 A~~ ✓ Vol 72

MOSURE HARRY

NWSE ✓

PO ✓ 40 A ✓ Vol 71

" " "

SWSE ✓

PO ✓ 40 A ✓ Vol 71

NITIZER, JACOB

NESE ✓

PO ✓ 40 A ✓ Vol 41

SMITH, PAUL M

PT SE SW ✓

X 40 A X Vol 71

MAYN FOSBY J.H. ETAL

BOYD, CHAS. H.

W $\frac{1}{2}$ NE & PT NW $\frac{1}{4}$ ✓

✓ 115 A PO ✓ 105-398
rec 193 Vol 94

VORHEES JESSE

SCHEN, HOMER & MAUDE

SWSE & SE SW ✓

PO ✓ 31.53 A ✓ 104-28
Vol 1

MARR, WULW & CHARLES

SW SW ✓

PO ✓ 41 A ✓ Vol 1

MOSURE HARRY 89-461

SMITH PAUL M. PO

PT SE SW ✓

PO ✓ 10.47 PO ✓ Vol 1 77

COOK ALBERT

NW $\frac{1}{4}$ PT ✓

40 91-495 Vol 9

M.E. CHURCH Vol- F.P. 528

SEC = 15

PANSY ETAL

WIE, DAVID & OPAL

LOTS-1-4 ✓

6A ✓

94-594
VOL 71 P 533

ELINS ESTEL

SE SE LOT-2

181A ✓

Vol-96-261

TERAFT LESTER

NW 1/4

23.50A ✓

Vol. 92-49

"

Sec 10⁷⁰⁰ LOT 2 PT

3.21 ✓

Vol-92-49

N HARVEY

W 1/2 SE LOT 2 PT

2 ✓

VOL-8 P 58

BAINTER JACOB

(W 1/2 NW)
CHAS CROSBY

Vol-105-169
Vol-102-377

ER, HAROLD

" " " " "

Vol-79-387

WILLIAMS V.L

LOT 2-PT

108.88 ✓

Vol-104-666

VOL 79-387

ALBERT

NE 1/4 & PT NE 1/2 SE

181A ✓

Vol. 91 P 495

CANTWELL CLIFFS INC

58 ✓ Vol-105-170

ED, BESSIE

" " " " "

26A ✓

VOL 72-179

PAUL

HARLES & WILLY

SESE & S 1/2 NESE

63A ✓

91-430

Vol-45 P 498

PAZLI

PT SESE PT LOT 2

3.50 ✓

VOL 80 P 57

W.M.C. ETAL

W 1/2 SE LOT 2 PT

96.62A ✓

VOL 70-113

LYTLE DONALD

YER ALBERT

PT SESE PT LOT 2

.50 ✓

98-518
VOL 82 P 492

VIGLEVER ALBERT

PT W 1/2 SE

96.1 ✓

Vol-90-619

DA JESSIE B.

91.41 ✓

VOL 82 P 388

Y. PAH

PT NE 1/4

40 ✓

95-85

Vol-84 P 48

58-631

40 Vol (1094)

V. B. CHURCH VOL 9 P. 140

M.E.

Vol-21 P. 585

S JESSE

ASHARES, VELMA	NW SW PT LOT 5	✓	18 A	PO	
CHAS OGLE					
EBY, RUTH VIVIAN	NW SW PT LOT 5	✓	15 A	PO	99-42 VOL 8
WYLIE, DAVID & OPAL	LOT=12	✓	24 A	PO	VOL 71
" " " "	" 11 PT	✓	.50 A	PO	" "
GLENN, HARLEY & MARGRET	LOT 4-PT	✓	2 A	PO	VOL 75 = P 330
" " " "	" " " "	✓	7 A	PO	VOL 73 P 51
" " W.		✓	15 A	PO	VOL 67 P=242
RUHN, GEORGE W.	LOT 4 PT	✓	19 A	PO	54 506 VOL 30 - 71
" ALLIE ET AL					
" NEAN	" " "	✓	41 A	PO	VOL 48 P=77
SEESHOLTZ CALLIE ET AL					VOL 105-128
MYER W M	LOT 2 PT & 9	✓	137 A	PO	VOL 93 TO 6
" " "	" 1-2 PT	✓	81 A	PO	VOL 73
WYLIE PANSY					
WOODS, T. B. & WYLIE DAVID	LOT 10	✓	39 A	PO	VOL 4
QUEEN STEVEN	LOT 3	✓	30 A	PO	VOL 8
KUHN RUSSELL					
RICKETTS VIRGINIA	PT LOT 7	✓	2.50		101 51 VOL 9
JONES, DOROTHY	NW SW LOT 3	✓	15 A	PO	VOL 2
MC GRADY ELIZABETH	" " " "	✓	10 A	PO	VOL 2
ALTER HAROLD	LOT 11 PT	✓	14.50	PO	
WOOD ELMA					
CLAR, O A	LOT 7 PT	✓	40.00	PO	
" " "	" " "	✓	150	PO	
KLINGER GEO	" 13 PT	✓	44	PO	
MC GRADY ELIZABETH	" 13 PT	✓	35	PO	
MC GRADY ELIZABETH					
HULL V. V					
SMITH EDSON					
" " "					

137 A PO VOL 93 TO 6

81 A PO VOL 73

WOOD ELMA

CLAR, O A

SEC = 17

HARLEY W LOT 2 ✓ ✓ 5 A PD VOL = 81 = 508
ER E. M. II ✓ ✓ 1 A PD VOL 75 = 337
94-265

ENN HARLEY & WIFE NENE ✓ ✓ 40 A PD VOL = 65 P = 35

JONES THEO
POLING, ALICE LOT 7 ✓ ✓ 51 A PD VOL 70 P = 382
101-122 92-430

REISER WILLIAM EFFIE NWNW ✓ ✓ 41 A PD VOL 37 P 161
VOL-99-230

MS GRADY ELIZA LOTS-3-4-5 PT ✓ ✓ 15 A PD VOL-47-P-523

II ELIZA LOTS-3-4-5 PT ✓ ✓ 20 A PD VOL-70-P-99
92-636

III IV Look for middle deed. ✓ ✓ 6 A II II

WIDMAIER LILLIAN
THERALD HARVEY & WIFE SWNE LOT 6 ✓ ✓ 74 A PD VOL-61-P-173
101-12 92-432

WIDMAIER JACOB
NWNE & NENW ✓ ✓ 82 A PD VOL-88-368
95-348

WIDMAIER J. & Isabelle C.
BURN, C.G. LOT 1 ✓ ✓ 5.6 A VOL 72 = 385

II II ✓ ✓ 1.4 A VOL-70-P494

EL OPAL SW COR. SW 1/4 ✓ ✓ .25 A PD VOL-92-262

WIDMAIER J. & Isabelle C. ✓ ✓ 55 A PD VOL-81-P-290
91-550 99-421

ROTHY ✓ ✓ 15 A PD VOL 82-452
96-424

✓ 7 VOL-81-P-33

LOT-3-4-5-PT ✓ ✓ 2/3 VOL-97-430
81-508 98-264
VOL-103-208

MOUND CROSSING - S. T.

R. 18 = T. 12

SEC = 7

CANFIELD ARCH S 1/2 SW 84 A ✓ Vol 77 - P = 295

MARTLEY RICHARD SW NW - NWSW 84 A ✓ Vol - 94 P - 18

SEC = 17

REISER WILLIAM
~~WOLTZ NAOMI~~ S 1/2 NW PO 82 A ✓ Vol ⁹⁹⁻²³⁰~~89-479~~ P 161

COOK JAMES NW SW PO 41 A ✓ Vol - 95 - 72

WIDMAIER LILLIAN
~~FETHEROLF, HARVEY & WIFE~~ E 1/2 SW PO 80 A ✓ Vol ¹⁰¹⁻¹²~~61~~ P 174

BAKER WOOD PRESERVING CO.
~~RICHMOND, LEVI, C~~ SW SW PO 41 A ✓ Vol ⁹⁶⁻⁴²⁵~~47~~ - P 221

MOUND CROSSING = S. II.
SEC = 18

BARNES ELMER	LOTS - 1-5	PO	4.6365 ✓	Vol-84-208
FRED ET AL CROSBY, MARTIN	LOTS 1-5 PTS	PO	70A ✓	96-130 Vol-70-P-533
BUCHANAN DONALD	A W 1/2 NW	PO	79A ✓	Vol-84-243
STAHR GOLDIE			40	
SKARR VIRGIL	LOT 2 PT	PO	60A ✓	VOL 96-241 3
" " " "	" " "	PO	10A ✓	" " "
STAHR GOLDIE				
SKARR VIRGIL	E 1/2 SE LOT 2 PT	Out	9.66 A ✓	Vol 96-241
REISER W. O.	SE SE PT	PO	8 A ✓	Vol 94-652
" " " "	S 1/2 NE PT	PO	20 ✓	" "
" " " "	E 1/2 NE PT	PO	12 ✓	" "
STAHR IARL	SW SE	PO	42 ✓	Vol 79-P-604
EIGENSEE HAROLD - ETAL		PO	.68 ✓	Vol-81-P-45
WILSON, LELAND & DORA	LOT 2-7 PTS	PO	3 ✓	Vol-71-P-379
WEUKER FLORA	LOT 4 68-506	PO	28 ✓	Vol-93-384
" " " "	E 1/2 NE PT	PO	10 ✓	Vol 93-381 30
Ben Bigham				Vol 71-868
BIGHAM BENJAMIN	LOT 3	PO	21 ✓	Vol-62-P-568
" " " "	LOT 2 PT	PO	70 ✓	" "
" " " "	LOT 1-5 PT	PO	72.839 ✓	" 80-P-370
HUNSFORD JAMES	E 1/2 NE PT	PO	7.50 ✓	Vol-53-P-319
LONGFORD GRVILLE REISER W.O.				102-82
BURCHMAN DONALD	LOT 2 PT	PO	23.80 ✓	Vol-94-50

SEC=18

SEESHOLTZ, WUHL, G E $\frac{1}{2}$ NEPT po 17.50 ✓ Vol-63 P 154

" " " " " " po 6 A ✓ " " " "

NEIGHBORGALL, DAYTON H. ETAL E $\frac{1}{2}$ NEPT po 2.31 ✓ Vol-79-P 141

" " " " " " po 3.69 ✓ Vol " "

✓ EIGENSEE, HAROLD ETAL LOT 8 po 34.82 ✓ Vol-81-P 45

LAUREL VALLEY GRANGE #2708
~~NEIGHBORGALL DONA~~ W $\frac{1}{2}$ SW $\frac{1}{4}$ 97-127
po 1 ✓ Vol-76 P-143

ARNETT RONALD PT LOT 4 po 13 Vol-94-117

MOUNT CROSSING = S.I.

SEC = 19

NEIGHBORGALL, DAYTON, H & WIFE	LOT-2 PT	✓	8 A	Vol-63-P-475
" " " " ETAL	" " "	✓	8.07	Vol-79-P-141
STARNER J.R. BIGHAM C.O.	" " "	✓	9.72 PO	105-253 Vol-92-392
" " " " " "	" " "	✓	18.46 PO	" " "
NEIGHBORGALL D.H. STARNER J.R.	" " "	✓	8.07	Vol-79-P-141
BARNES ELMER & ELLA	PT E/2NW	✓	40.34 PO	105-253 Vol 84-268
McDOWELL, J.B. FRANCIS	W/2 SW PT	✓	10	83 Vol-81-P-517
PEDERSEN DOROTHY MEYER MILDA	W/2 SW PT	✓	30.50 PO	95-31 Vol-84-P-121
EDWARDS ^{Mrs. Sullivan} ETAL	LOT 1	✓	8 A PO	Vol 57-P-384
STATE OF OHIO	W/2 SE PT	✓	35.50 PO	Vol 64 P 72
" " "	" " "	✓	23.43 PO	Vol 75 P 189
EDWARDS E.E.	" " "	✓	31.36 PO	89-188 Vol 72 P 253
WILKINSON, PROPERTIES INC.	SE SW	✓	PO	
COLLETT, GRACE	PT SE SW	✓	.88 PO	Vol 79-P-444
" " "	" " "	✓	10 PO	" " " "
PURCELL, CHAS. & WIFE	" " "	✓	1 PO	Vol 87-P-80
EDMONDS, HARGREAVES	W/2 SW	✓	14 23 PO	Vol 73 P-546
STATE OF OHIO	W/2 SE & N/2 SW & SW SE	✓	171 PO	Vol 58 P 157
" " "	PT E/2 NW	✓	43.75 PO	Vol 75 P 189

SEC=19

- ✓ EIGENSEE, HAROLD, ETAL NWNE PO ✓ 140 ✓ VOL 81 P 45
- ✓ POWERS, JOSEPHINE E NENE PO ✓ 45 ✓ VOL 71 P 294
- ✓ ARCHER, ALBERT E. E 1/2 SE 8 SE NEPT PO ✓ 100 ✓ VOL 76 - P 555
- ✓ MARKS, MARY LOUISE S 1/2 SE 1/4 SE 1/4 PO ✓ 20 ✓ VOL 67 - P - 596
- ~~BIGHAM RAYMOND~~ STARNER J. R. 105-253
- ~~WOODGEARD HAZEL~~ PT E 1/2 NW 91 VOL 76-143
- ~~WOLFORD LIONEL~~ PT W 1/2 SW PO 9 96-212
VOL 86 P 152

35.50
 $\frac{12}{47.50}$
 $\frac{10}{37.50}$

43.75
 23.43
 $\frac{20.32}{67.18}$

8
 9.72
 18.46
 $\frac{8.07}{44.25}$

32.2
 $\frac{10.9}{43.1}$

9.72
 18.46
 8
 8.07
 10.
 8
 8
 $\frac{71.25}{111.25}$

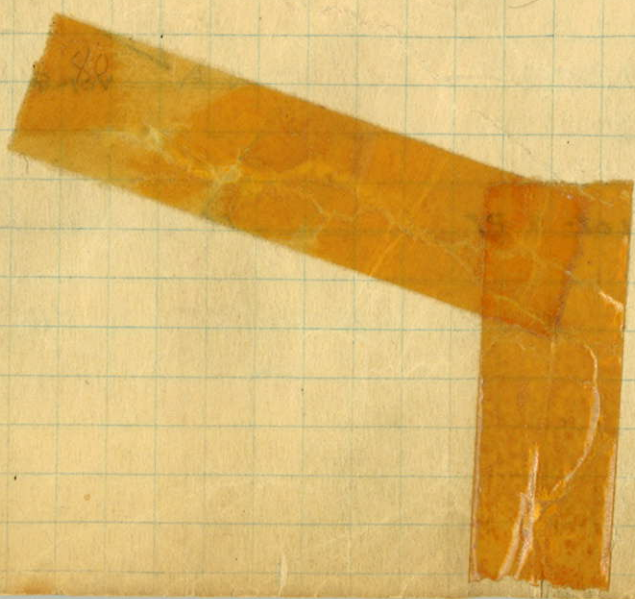

SEC=20

94.5
41
131.5

✓ FUME, JOE	LOT 2 ✓	37.42 A ^{PO}	= VOL 61-P
" " JR		.36	Vol- 99-48
✓ MARK, CLARA G	PT 11 2 ✓	4.58 A ^{PO}	VOL-67-P-41
" " G	" " 2 ✓	.92 ✓	VOL 83 P 6
" " "	" " 1 ✓	7.50 A ^{PO}	VOL 67 P-5
✓ KEISTER OTTO	LOT 3 PT ✓	4 A ^{PO}	VOL 77 P 35
FAST PAUL	LOT-3-PT	1.28	103-590 82-619
✓ ROBINSON, CHAS	LOT 3 PT ✓	55 A ^{PO}	VOL 66-267
" " " "	LOT 3 " ✓	20 A ^{PO}	VOL 72-150
MOORE, HAROLD ET AL	W ¹ / ₂ NW ✓	92 A ✓	
" GRANT HEIRS	W ¹ / ₂ NE ✓	80 A ✓	
KUHN CLAYTON	E ¹ / ₂ NW ✓	80 A ✓	W ¹ / ₂ NE 100 VOL-92-644
" " "	NW ¹ / ₂ W ¹ / ₂ NE ¹ / ₂ SE ✓	89 A ✓	" " "
MOORE DAISY ET AL	E ¹ / ₂ NE ✓	41.42 A ^{PO}	VOL 75 P 51
WILLISS RALPH			82-554
✓ ARCHER, ALBERT E	LOT-1 PT ✓	34.55 A ^{PO}	VOL 76-55
✓ OGLE C. R.	PT NE ¹ / ₄ ✓	12.70 A ^{PO}	VOL 83 P 13
MILBURN, C. G.	PT NE ¹ / ₄ ✓	10.78 A ^{PO}	VOL-7
" " "		18.57 A ^{PO}	VOL
OGLE, CHAS. R.	E ¹ / ₂ SE ³ / ₄ ✓	84 A ^{PO}	VOL
DI FUEL BASSO	LOT-3 PT ✓	4.50 A ✓	VOL

SEC = 21

WYLIE, DAVID & OPAL	LOT 1 PT	✓	39.75 ^{PO}	Vol 71-P533
" PANSY & BRASHARES VELVA	W 1/2 SE	✓	85 ^{PO}	Vol 39 P 398
HUFFINES, EMERY	LOT 1 PT	✓	1.25 ^{PO}	Vol 57 P 615
STATE OF OHIO	SE SE	✓	43 ^{PO}	Vol 61-P-9
VORHEES, MYRELE	LOT 2	✓	2 ^{PO}	Vol- 94- 257 7
HUFFINES EMRY	"	✓	11/16 ^{PO}	Vol-101-381
FTZBELL DOYS	"	✓	22 ^{PO}	105-452
KUHN CLAYTON	E 1/2 NENW	✓		Vol 86-P-73
BRASHARES NEVADA J.	SW NE	✓	42 ^{PO}	Vol-39-399
BENSONHAVER LULO	PT S E NE	✓	.50 ^{PO}	Vol-105-4
WHITCRAFT JOHN	NOT 3 NENE	✓	70 ^{PO}	'VOL-62-P-105'
BRASHARES N J				92-270
WOODS T. D. & WYLIE DAVID	NW NE ①	✓	42 ^{PO}	Vol-41-P-480
WYLIE PANSY ET AL				94-394
KLINGER GEO	W 1/2 NENW	✓	20 ^{PO}	Vol-95-521
"	SW NW	✓	42 ^{PO}	Vol-95-521
CAUDILL DELBERT	SWSW	✓	43 ^{PO}	92-470
SHOMBER F.W. ⊗				Vol 86-P-464
OGLE CHAS	NW SW	✓	42 ^{PO}	Vol-63-P-183
KIBLER, FRED W & GENEVA	NW NW	✓	42 ^{PO}	101-84
Kibler Genevieve				99-369
GRIFITH, WALTER R	E 1/2 SW & SENW	✓	1.25 ^{PO}	Vol-70-P-161
SOUTH CENTRAL	ELECTRIC INC		418	Vol 86-520
WHITCRAFT JOHN	PT SW NE		.50	Vol 96-117
ANDERSON JOHN	NATE ANDERSON		.57	103-258
WHITCRAFT JOHN	"		.50	Vol-98-159
ANDERSON B.L	"		.69	Vol-101-643

U. B. " Vol. P- P-382
M.E. CHURCH Vol. I, P. 354

SEC = 22

VORHEES	ESTELLA J E	LOT 6 PT	PO	27	98-126 Vol-27-P-30
"	" "	LOT 4 PT	PO	78.85	Vol-35-330
"	JOEL	" 4 "	PO	1	Vol-31-P-464
"	" E		PO	25	Vol-46-P-489
"	NORMAN & RUTH	PT W 1/2 NE	PO	.81	Vol-78-P-409
WINE	OTIS ROSA M	SE SE	PO	44	96-232 Vol-59-P-312
STIMMEL PAUL		LOT 3 NESW	PO	50.56	Vol-91-91 Vol-74-P-336
MOORE, GRANT		LOT 4 PT	PO	.02	Vol-34-555
MYER, BRIDGET BERTHA		LOT 6 E 1/2 NW & W 1/2 NE	PO	183	Vol-81-P-610
LAUREN BOY	EDUCATION	EXEMPT			
STATE OF OHIO		W 1/2 SE	PO	88	Vol-61-P-9
"		LOTS-1-2	PO	13.50	" " "
VORHEES JESSE					
STEVENS, HOMER & MAUD		E 1/2 NE & NE SE	PO	183	104-28 Vol-47-600
STIVERSON, ARCHIE J.		E 1/2 NE NW PT	PO	3	Vol-40-P-358
FRANCIS, VELMA		SE SW	PO	1	Vol-78-P-120
RUSSELL, GOLDIE		SE SW	PO	43	Vol-85
STIMMEL PAUL					
" S M		PT NW NW		8	95-87 Vol-85-P-97
STIMMEL PAUL		NE SW		44	Vol-91-91

SEC = 23

Rishbaum

RISHBAUM GEORGE ✓ LOT 1-PT 3 ✓ 75A VOL-49-P 603

ROSE WIL ✓ LOT 1 PT E 1/2 NE ✓ 139A VOL-64 P 67

RINN FRANK. ✓ LOT 4 PT ✓ 5 VOL-83 P 264

JESSE

SCHNEIN, HOMER & MAUDY ✓ LOT 2 NWNW ✓ 94A VOL 40 P 620

SMITH, PAUL M & JOHNSON, CONSTANCE SMITH ✓ LOT 2 N PT ✓ .06 A VOL 71-P 273

OTIS
VINE, ROSA M. ✓ 1/2 NW & NW SW & SW SW ✓ 170A VOL-59-P 312

AIREN HOWARD F ✓ E 1/2 SE ✓ 85A VOL 83 P 597

ME via. M. ✓ Lot 4 pt 5 VOL 84-491

of Ohio

105 VOL 127 P 511

NE NE (40)

SA Wm F Hooper

S 1/2 NE

29

Rishbaum

SA-SE end W 1/2 of SE 1/4

E 1/2 of E part of SA of SE end E 1/2 of SW 1/4

SEC-24

✓ AIKEN H. ✓ WIFE. W $\frac{1}{2}$ SW-SESW-NESW	✓	65.52 150A	✓	VOL-83 P 53
STATE OF OHIO. F SWNW	✓	21.5	✓	Vol-
NORTH NOEL N $\frac{1}{2}$ NE	✓	86A	✓	Vol-92-6181
III " " " " NESE	✓	43A	✓	92-6181
" " " " S $\frac{1}{2}$ NE	✓	86A	✓	92-6181
✓ BESUTEN, OLGLA, W. W $\frac{1}{2}$ SE	✓	86A	✓	VOL-84-P-29
✓ HEIGLE, JOHN R SESE	✓	43A	✓	105-241 VOL-38 P 976
AZBELL NELSON LOT 1	✓	34A	✓	Vol-94-180
SMITH SAMUEL C. LOT 2. SENW-W $\frac{1}{2}$ NESW	✓	112A	✓	VOL-51-P-76
KAUFMAN WYNONA W $\frac{1}{2}$ SWSESW-NE.SW	✓	84.02	✓	Vol
" " " " PT SWNW	✓	21.5	✓	Vol



SEC=25

Amon James G.

W 1/2 SW - SWNW

1.24 A

Vol 87 P 119

BLACK JACK HUNTING & FISHING CLUB INC. Lot 3-5 Pts

7.98

Vol 51 P 479

" " " " " " SWNE

42.51

Vol 61 P 459

" " " " " " Lot 6

2.00

Vol 51 P 479

LYONS, ^{HELEN} CLAUDE C

Pt lot 6-3

.51 A

100-505
Vol 81 P 35

SCHWENKE, G. S.

Pt lot 6

.45 A

Vol 81 P 227

REIDER ROY

PT LOT-3

.33

Vol 102-141

JILLON, WILLIAM M.

Lot - 3-5 Pts

PO

3.55

Vol 27 P 475

PRINTZ DONALD F.

MICHEL, JOHN

Lot 10

PO

5 A

Vol 61 P 149

" "

" 4-8-9 Pts

PO

8 A

Vol 61 P 341

" "

" 9-5 Pts

PO

26 A

Vol 61 P 149

ANNA ET AL

KECK, CLINTON

LOTS 1-2-3 PT

PO

67.78

98-374
Vol 35 P 380

M. TINGER SP. BERT

WALKE, HAROLD & IRMA

SESW LOTS 4-8-9 Pts

PO

121.72

95-620
Vol 83 P 373

AIKEN HOWARD F. & WIFE NWNW

PO

41 A

Vol 83 P 536

BRYANT HENRY

HEIGLE, MARTIN

SENE-PT Lot 9

PO

45 A

101-540
Vol 48 P 564

" "

NWNE & NENW

PO

77
82 A

Vol 38 P 174

BEIGLE JOHN, R.

NE NE

PO

41 A

105-241
Vol 38 P 474

" "

" "

PO

41 A

Vol 57 P 602

W. FEMAN JAMES

Lot 6

5

Vol 85 P 32

VINCENT B.

LANNING ALFRED

PT NWNE

5

Vol 86 P 601

E. CHURCH Vol 18 P 437

SEC = 27

- ✓ STATE OF OHIO W 1/2 SE ^P ✓ 82 VOL 61 P. 9
- ✓ STATE OF OHIO ^P W 1/2 SW ✓ 82 VOL 89-492
- ✓ " " ^P E 1/2 NE & NESE ✓ 126 " " "
- ✓ KUHN JOHN SE SE ^P ✓ 42 VOL 87 P 584
- ✓ RUSSELL BERNARD & GOLDIE E 1/2 SW lot 1 ^P ✓ 11 VOL 76 P 422
- ✓ " " " W 1/2 NE 2 PT ^P ✓ 157 " " " "
- ✓ ROWLAND, HERMAN ETAL W 1/2 NW ^P 82 VOL 75 P 225
- BUDD PAUL
~~LEITASTER CM~~
- ✓ KELLER, JOHN F. WAS SCHOOL LAND ^P ✓ .50 VOL 72 P 186
- ✓ STATE OF OHIO E 1/2 SW PT ^P ✓ 82 VOL 61 P 9

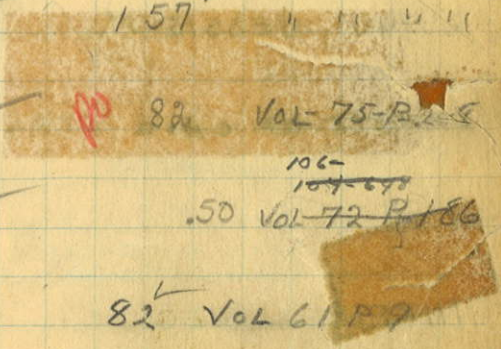
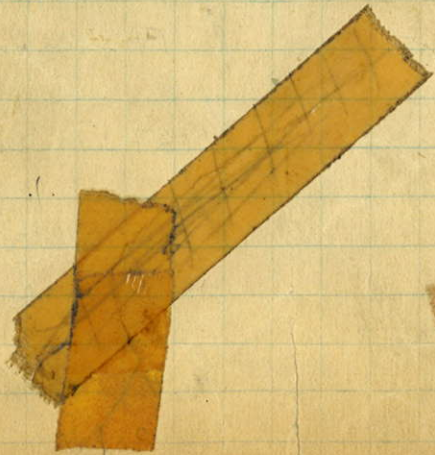

SEC = 28 43-544

BAINTER J. R. SWNW Lot 1 50A Vol-67-P-635

MOORE FLOESSIE SW. COR 90 SQ FT Vol-91-401

KLING SHELTON BAITER IRA Vol-67-632 NW SW & SCHOOL LOT & BLD. 35 A Vol-91-401
Pt SW SW 20 1/4 Vol-97-481
35 A Vol-91-400

KLING ELLA SE SE 29 A Vol-59-P-213

VORHEES MYRTLE SE SE 15 A Vol 70 P 426

" " NW SE 27 " " " "

" " 1/2 NW PT 16 " " " "

" " PT E 1/2 SW - SENW - SESE 47 " " 90-585 "

HUFFINES, ROY & WIFE MINEHART LESTER NW SEPT 15 Vol 63 P 49

" " " " E 1/2 SW & SENW & SESE 105 Vol 63 P 119

HUFFINES EMDRY L N 1/2 NW PT 5 Vol 56 P-95

BRASHARES, NEVADA ETAL NW 1/4 PT SW NE 12 Vol 59 P-99

" NEVADA J. NNW NE PT 1 Vol-39-P-399

WYLIE, PANSY & BRASHARES VELVA SW NE - PT E 1/2 NE 4 1/2 Vol-39-P-398

ROWLAND HERMAN ETAL NE SE & PT E 1/2 NE 125 Vol 75 P-258

SANDERS CHAS BRASHARES N 1/2 NW PT 61 Vol-91-208

WANDYKE HARLES N 1/2 NW PT 44 Vol 83 P 595

By the looker HART 199 looker PT NW SW 1/4 90 rods Vol 87-174
15 Vol 87-324

Official Plat Book Recorder, Franklin County, O. Entered in Record MAR 5 1946

SEC = 29

✓ BAINTER, INEZ & J.R. NENE PO ✓ 41 Vol-50-P607

✓ " J.R. LOT 1 E/2SE PO ✓ 45 Vol 67 P 634

KERR L. ✓ GLENN HARLEY 12 Vol-105-307

✓ " IRA SE SE PT PO ✓ 33 Vol 57-292

CARROLL J ETAL ✓ COOK RICHARD 102-579

✓ VOGEL CHAS W. SW NE PO ✓ 41 Vol 71 P 411

CHILLOCTHE REALTY ✓ SHAW EDSON 105-197

✓ CALVERT RODNEY N. W 1/2 SW PO ✓ 81 Vol 39 P 437

COURTWRIGHT HARRY ✓ PATTERSON LOUISE PT W 1/2 SW 105-490 3 Vol-105-216

LYNN, JESSIE M. SENE PO ✓ 40 Vol 71 P 212

STATE OF OHIO ETAL LOT 2 PT PO ✓ 32 92-525

" " " " 1/2 SE PT PO ✓ 37 Vol 100-231

CHILLOCTHE REALTY ✓ SHAW EDSON 105-197

HURFES, GEO. LOT 2 PT PO ✓ 8 Vol 78 P 461

" " " " E 1/2 SW PT PO ✓ 59 Vol 78 P 461

HARBAUGH, MELROSE E 1/2 SW PT PO ✓ 1 Vol 76 P 545

ROBINSON, V. CHAS. A. LOT 5 PO ✓ 30 Vol 66 P 267

DEED READS IN SEC = 28

Mrs BROOM HOWARD ✓ KEISTER OTTO WIFE S 1/2 NW & NW SE PT PO ✓ 130 Vol 77 P 35

ROBINSON, Chas A. LOT 4 PT PO ✓ 4 Vol 48 P 31

AUSTIN LLOYD PT S 1/2 NW PO ✓ 10 82-619

FLUME JOE NWNW PO ✓ 14 Vol 61 P 86

LLOYD AUSTIN " " PO ✓ 7 Vol-97-46

MARR CLARA S. NWNW PO ✓ 27 Vol 67 P 410

DAXTON CHAS. LOT 3 PT PO ✓ 10 Vol 71 P 461

" " " " " " PO ✓ 10 " " "

" " " " " " PO ✓ 10 " " "

HARLEY GLENN ✓ MARR ETAL S 1/2 SE PT PO ✓ 9 99-454

PT NE SE 1/4 PO ✓ 10 Vol-37-14T

Vol 87-174

SEC=30

STATE OF OHIO

SESE LOT 1

✓ PO

77

VOL 62 P-196

NWSW & E 1/2 SW

✓ PO

124

VOL 62 P196

SE 1/4

✓ PO

165

VOL 59 P412

NIBBIO JAMES

CURRY, G. H. & ASKREN R. H.

LOT 4 PT

✓ PO

85.50

104-110

VOL 65 P411

JONES CHAS

KINKER J. H.

SWSW

✓ PO

41

95-97

VOL 31 P 209

State of Ohio Lot 3

Maries, Mary Louise NENE

McDowell, J. B. F. Trustees Lot 2

~~COURT WRIGHT HARRY~~
~~PATTERSON LOUISE~~

~~P 1/2 SW~~

46

42

79

VOL 18 P 412

VOL 67 P 590

VOL 67 P 597

~~5 VOL 105 P 216~~

EDWARDS L. ET AL

VOL 5-P-180

Vol. 64-P-19

Not a title

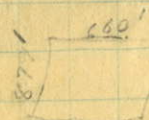

SEC = 31

✓ BURGDOON, ELIZABETH	LOT 2	- PO ✓	14	VOL 30 - 325
DAVIS FRIEDA ETAL				99-183
✓ MOORE, HAROLD ETAL	SW NE	- PO ✓	41	VOL 40 - P 359
✓ " " "	LOT 10	- PO ✓	48.50	VOL 40 - P 360
JONES CHAS				95-97
✓ KLINKER, JOHN H.	NWNE - NEKW	✓ PO ✓	90	VOL 23 - 171
✓ " " "	LOT 6	✓ PO ✓	40	VOL 27 - 375
SANDERS, ALPHEUS	LOT 11	✓ PO ✓	29.50	VOL 74 - 614
" "	LOT 10 PT	✓ PO ✓	9	VOL 70 - 255
" "	LOT 1	✓ PO ✓	17	VOL 67 - 605
" "	NESE - SENE	✓ PO ✓	110	VOL 66 - P 51
✓ STATE, OF OHIO	SE NW	✓ PO ✓	41	VOL 62 - 196
C HAPPELL, TAILOR & PATTERSON	SWSW LOT	✓ PO ✓	45	VOL 71 - P 26
BLACKWELDER JULIUS				94-633
✓ RUSSELL, ORTEL	LOT 8	✓ PO ✓	25	VOL 74 - P 41
GOD WILLIS RALPH				100-60
✓ BARRINGER, A. W.	LOT 4	✓ PO ✓	12	VOL 94 - P 157
OTTO				102-439
✓ KEISTER, GOLDIE	LOT 5	✓ PO ✓	71	VOL 66 - P 163
Ranney, Pauline V Etal				82-573
✓ WILDCRAFT, W.C.	NWSW - SWNW	✓ PO ✓	80	VOL 51 - P 534
MRS WILLIAM K ETAL				VOL 84 P 147
✓ EDWARDS, AMT	LOT 6 PT	✓ PO ✓	3	VOL 73 - P 7

lot 3

SEC = 32

STATE OF OHIO	W $\frac{1}{2}$ SW	✓ PO ✓	84	Vol-89-492
STATE OF OHIO	LOTS-1-2-3-4 PTS E $\frac{1}{2}$ SW PT	✓	221	Vol-90-9
" "	SW NE-PT NE NW	✓	86.86	" " "
" "	NE NW PT	✓	PO 19.75	" " "
" "	SE NW PT	✓	1 PO 47	" " "
" "	SE NW PT	✓	41 PO	" " "
" "	SE NE	✓ ✓	PO 43 ✓	" " "
QUILLIGAN, MAUD E.	NW NW	PO ✓	✓ 42	VOL-72-198
WM ETAL POLING ISAAK	LOT 3 PT.	✓ PO	31	99-293 Vol-4-P-391
STATE OF OHIO	E$\frac{1}{2}$ SE	✓ PO ✓	86	Vol-88-97
STATE OF OHIO	SW NW	PO ✓	✓ 42	Vol 59-4/30

V. B. CHURCH Vol-30 P. 232

PLATS of SECTIONS BOOK A, ORIGINAL SUR 1869

SEC = 33

STATE OF OHIO	✓	SW SE	PO ✓	44	Vol-81-599
" " "	✓	SE SE	PO ✓	44	Vol 61-P343
" " "	✓	NW SE	✓	45	Vol 58 P435
" " "	✓	NES W	✓	42	" " "
DISMEIER CLARENCE		PT SW 1/4 NW 1/4		12	Vol-105-204
JANDYKE HARLES		S 1/2 SW PT	PO ✓	36	" " 97-475 "
WYSKIVER HELEN	PO ✓	LOT 1	✓	22	Vol-83 P575
VORREES, MYRTLE	✓	NE SE	PO ✓	45	Vol-70-P426
" "	✓	SE NE	PO ✓	46	" " "
" "	✓	LOT 2 PT	PO ✓	49	" " "
				See Vol 43-P280	
KLINE ELLA	✓	LOT 2 PT	PO ✓	25	Vol 59 P-213
WONG, BERT S EDNA	✓	S 1/2 SW PT	PO ✓	30	Vol 70 P 642
" " "	✓	" " "	PO ✓	20	" " "
" " "	✓	NW SW	PO ✓	42	" " "
BLACK FRANK					
FERGUS HARRY	✓	LOT 3 PT	PO ✓	43	103-478 Vol 29 P 301
" HAROLD	✓	LOT 4 "	PO ✓	6	Vol 77 P 522
STATE OF OHIO	✓	LOT 3 PT	PO ✓	39	91-529 Vol 45 P 575
" " "	✓	SW NE	PO ✓	46	" " "
BRAUN BEATRICE					103-162
WING	✓	LOT 4 PT	PO ✓	28	94-204 Vol-61 P 374
" " "	✓	" 4 "	? PO ✓	46	" " "

74

SEC = 34

- STATE OF OHIO NOT 1 PT SWSW PT ✓ 7 ^{PO} Vol. 89-399
- STATE OF OHIO " " " " LOT 3 ✓ 158 ^{PO} Vol. " "
- STATE OF OHIO E 1/2 NW ✓ 84 ^{PO} Vol. "
- FRANZEN RUTH ✓ 95-580
- STIERS, ROXANNA ETAL LOT 2 ✓ 6 ^{PO} Vol. 52 P-62
- STATE OF OHIO W 1/2 NW ✓ 85 ^P Vol. 88-602
- BROOKS VERNA NWSE 1/2 & PT E 1/2 SE ✓ 128 ^{PO} Vol. 42-B 88
- " " " " PT SWSE 1/2 & PT E 1/2 SE ✓ 34 ^{PO} Vol. 88-P 285
- STATE OF OHIO NE 1/4 ✓ 171 ^P



NE SE - SE NE

SEC=35

VINCENT ROBT.	NW 1/2 NE	✓	84	VOL 85 P 68
STATE OF OHIO SHEIK, JOHN	W 1/2 NW	✓	84	88-285 VOL 19 P 591
BROOKS, VERNA	W 1/2 SW	✓	85	VOL 42 P 88
KUHN JOHN S.	E 1/2 NW - NE SW	✓	126	VOL 87 P 584
" "	NW SE	✓	42	" " "
KECK, EARL & TOTTIE	S 1/2 SE LOT 2	✓	103	VOL 74 P 532
" " " "	SE NE & NE SE	✓	84	VOL 66 P 273
KUHN JOHN EDELMAN BERMAN	SW NE	✓	42	87-584 VOL 83 P 112
BURNS CLAUDE RHEINSCHELD MAUD	LOT 3	✓	25	100-494 VOL 70 P 115

221
86
42

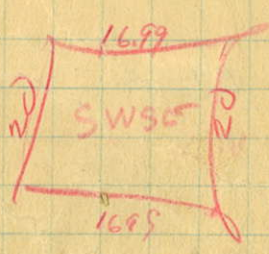

SEC = 36

STATE OF OHIO

SENE

PO ✓ 426

VOL 81 P 62

" " " "

SWNE

PO ✓ 426

" " " "

KECK, ^{ANNABETAL} CLINTON

LOTS 1-2 PTS

PO ✓ 74

³⁷⁶
⁹⁸⁻³⁷⁴
VOL 70 P 201

" " " "

NWNW

✓ 426 PO

VOL 70-201

HETTINGER SEIBERT

WALKE, HAROLD & IRMA

NWNE-NENE LOT 1 PT

✓ 85 PO

⁹⁵⁻⁶²⁰
VOL 83 P 378

HARBLE, SHERMAN & FERN

NE SW

PO ✓ 41

VOL 78 P 17

" " " "

"

LOT 2 PT

PO ✓ 4

" " " "

" " " "

"

LOT 2 PT

PO ✓ 5

67-426

" JOHN S.

LOT 3

PO ✓ 37

VOL 61 P-61

STATE OF OHIO

NESW PT

~~PO~~ ✓ 1

~~VOL 67 P 606~~

STATE OF OHIO

W 1/2 SE - PT SE SW

PO ✓ 90

~~VOL 79 P-38~~

STATE OF OHIO

W 1/2 SW - SWNW

✓ 26 PO

~~VOL 43 P-493~~

Huffines Emory

E 1/2 SE

✓ 84 PO

VOL 87 P 308

GIBSONVILLE

HUFFINES EMORY	LOT 1 ✓	VOL-44-P-116
" "	LOT 2 ✓	" " "
TRUSTEES M. E. CHURCH	" 4 ✓	VOL-22-P-120
WYLIE DAVID & OPAL ET AL	" 5 ✓	VOL 71 P 533
WYLIE OPAL & PANSY		
GIBSON J. M.	" 6 PT 2 ✓	VOL ¹⁰⁰⁻⁶⁰⁵ 50 P 45
FLORIDA JESSIE		
KELLAR J. F. & C. E.	" 6 " PT ✓	VOL ⁸⁹⁻⁶⁹ 74 P 251
" " " " "	" 7 ✓	" " "
CARR PAUL	" 8 ✓	VOL 81 P 55
ANDERSON JAMES JR	" 9 ✓	VOL 46 P 235
" "	" 10 ✓	" " " "
ANDERSON B. L.		
BELL CHAS E	" 11 ✓	VOL ⁹⁸⁻²⁴⁸ 52 P 607
WHITCRAFT JOHN	" 12 ✓	VOL 62 P 105
" "	" 13 PT ✓	" " " "
" "	" 14 " ✓	" " " "
VORHEES F. E. ET AL	" 15 ✓	VOL 85 P 638
TRUSTEES L. B. CHURCH	" 13-14 PT ✓	VOL-54-P-126
VORHEES F. E. ET AL	" 16 PT ✓	VOL 85 P 638

GIBSONVILLE

ANDERSON B.L.	NOT 16-17 PT ✓	VOL-64-P-481
KUHN CLAYTON ET AL MOORE W.M.	" 18 ✓	⁹¹⁻²⁹² VOL- 24 -P-142
GIBSON ^{J.M.} W.M.	" 19 ✓	VOL 17 P 51
BD OF ED	" 20 ✓	¹⁰¹⁻³⁸ VOL 84 P 212
CALLAHAN DON R.	" 21 ✓	VOL 71 P 452
W. H. BD OF ED IMP. ORDER RED MEN	" 22 PT ✓	¹⁰⁰⁻⁵⁵⁰ VOL 51 P 204
" " " "	" 22 PT	" " "
BELL CHAS E	" 1 ✓	VOL 52 P 607
HAMPSHIER GERALD	" 2 ✓	VOL 86 P 263
" "	" 3 ✓	" " "
" "	" 4 ✓	" " "
VORHEES MYRTLE B	" 5 ✓	VOL 94-257
" " "	" 6 ✓	VOL-94-257
M.E. CHURCH	Vol-52-P-12	PT Lot 22
U.B "	Vol-54-P-126	PT Lot 13-14 PT