

HOC - C.R. 118 - 0.14
SECTION 23, TOWNSHIP 13 NORTH, RANGE 18 WEST
GOOD HOPE TOWNSHIP
HOCKING COUNTY

MONUMENT LEGEND

[M] PROPOSED ADJUSTABLE CENTERLINE MONUMENT

(B)
 EXISTING R/W AND
 SURVEY & CONST. CURVE DATA
 P.I. 18+46.27 (C PR. R/W STA.)
 $\Delta = 57^\circ 47' 03''$ Lt
 $D_c = 45' 50' 12''$
 $R = 125.00'$
 $L = 126.07'$
 $T = 68.98'$
 $E = 17.77'$

(1)
 EXISTING R/W CURVE DATA
 P.I. 10+60.29
 $\Delta = 18^\circ 39' 49''$ Rt
 $D_c = 28' 38' 52''$
 $R = 200.00'$
 $L = 65.15'$
 $T = 32.87'$
 $E = 2.68'$

(2)
 EXISTING R/W CURVE DATA
 P.I. 12+94.23
 $\Delta = 60^\circ 34' 25''$ Lt
 $D_c = 76' 23' 40''$
 $R = 75.00'$
 $L = 79.29'$
 $T = 43.80'$
 $E = 11.85'$

(3)
 EXISTING R/W CURVE DATA
 P.I. 15+64.21
 $\Delta = 18^\circ 14' 35''$ Rt
 $D_c = 28' 38' 52''$
 $R = 150.00'$
 $L = 47.76'$
 $T = 24.08'$
 $E = 1.92'$

(A)
 PROPOSED R/W AND
 SURVEY & CONST. CURVE DATA
 P.I. 12+16.27
 $\Delta = 24^\circ 20' 06''$ Lt
 $D_c = 5' 00' 00''$
 $R = 1145.92'$
 $L = 486.70'$
 $T = 247.08'$
 $E = 26.33'$

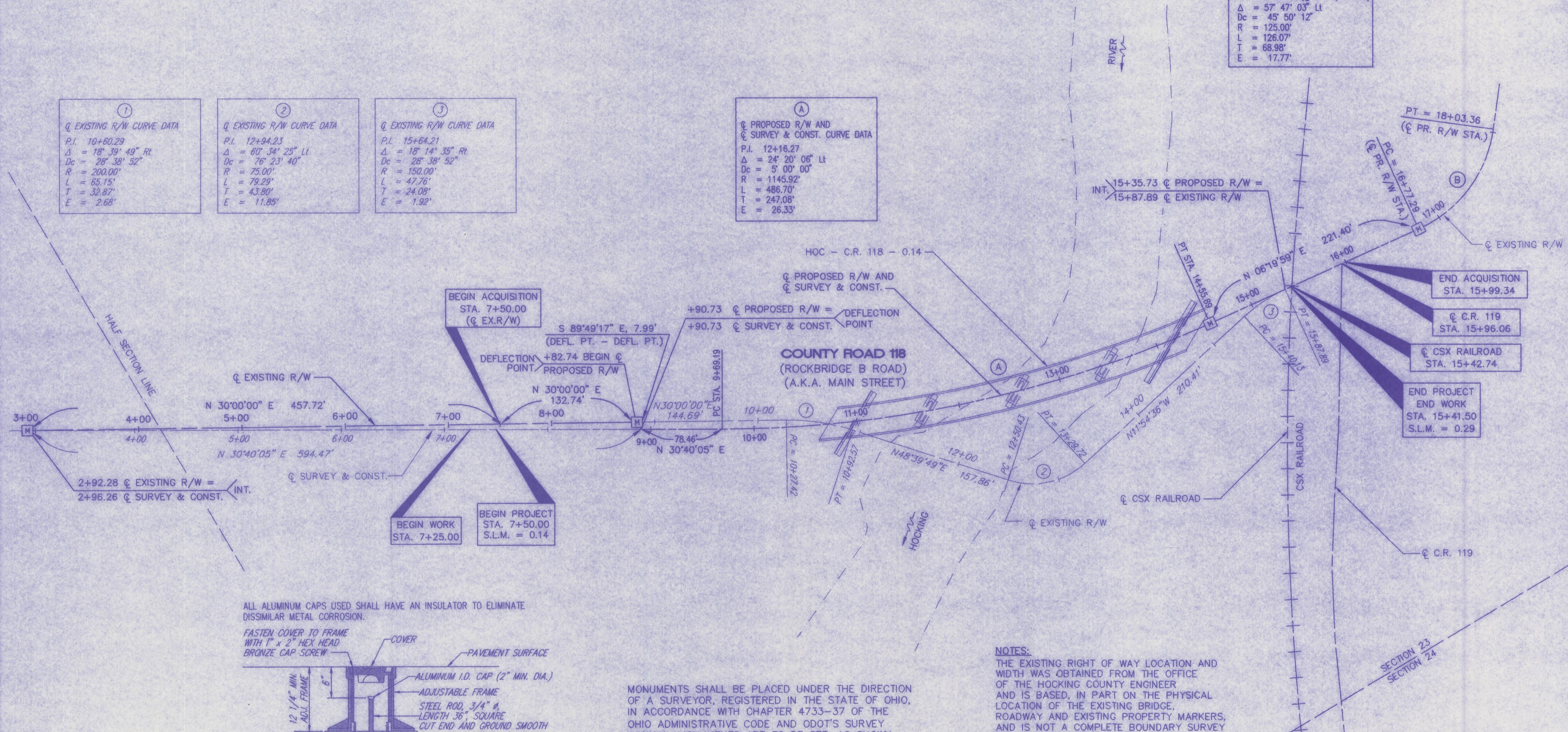

REVISION	DATE	DESCRIPTION

FIELD REVIEW BY: _____ DATE: _____
 OWNERSHIP VERIFIED BY: _____ DATE: _____
 DATE OF COMPLETION: AUGUST 5, 2002

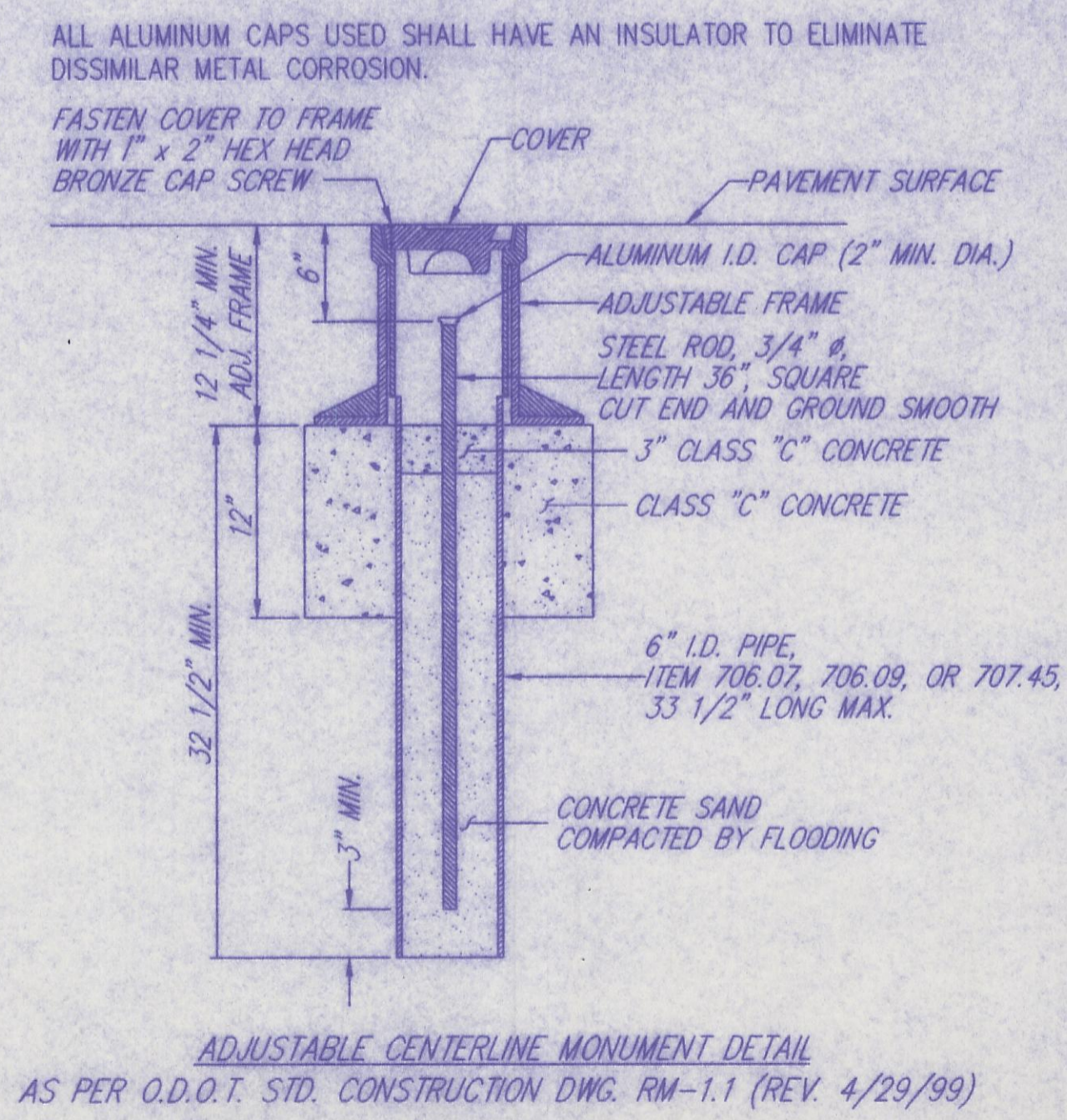

MONUMENTS SHALL BE PLACED UNDER THE DIRECTION OF A SURVEYOR, REGISTERED IN THE STATE OF OHIO, IN ACCORDANCE WITH CHAPTER 4733-37 OF THE OHIO ADMINISTRATIVE CODE AND ODOT'S SURVEY MANUAL. MONUMENTS ARE TO BE SET, AS SHOWN, BY THE HIGHWAY CONTRACTOR AT THE TIME OF CONSTRUCTION. IF DEVIATIONS CANNOT BE AVOIDED, THE SURVEYOR SHALL OBTAIN PRE-APPROVAL FOR THE NEW MONUMENT LOCATIONS FROM THE HOCKING COUNTY ENGINEERS OFFICE AND SHALL NOTIFY THE H.C.E.O. OF THE NEW MONUMENT LOCATIONS AS SET.

ADJUSTABLE C MONUMENTS AS PER PLAN TO BE SET DURING CONSTRUCTION		
STATION	DISTANCE FROM C	ADJUSTABLE C MONUMENT
2+92.28	ON C EX. R/W	P.O.T.
8+82.74	ON C EX. R/W	DEFLECTION PT.
14+55.89	ON C PR. R/W	PT
16+77.29	ON C EX. R/W	PC (C PR. R/W STA.)
TOTAL (CARRIED TO CONSTRUCTION SUMMARY)		4

NOTES:
 THE EXISTING RIGHT OF WAY LOCATION AND WIDTH WAS OBTAINED FROM THE OFFICE OF THE HOCKING COUNTY ENGINEER AND IS BASED, IN PART ON THE PHYSICAL LOCATION OF THE EXISTING BRIDGE, ROADWAY AND EXISTING PROPERTY MARKERS, AND IS NOT A COMPLETE BOUNDARY SURVEY OF THE PROPERTIES INVOLVED IN THE DEVELOPMENT OF THESE PLANS.

I HEREBY CERTIFY THAT THIS PLAT IS A TRUE DELINEATION OF A SURVEY MADE FOR THE HOCKING COUNTY ENGINEER IN MARCH 2001 BY COLUMBUS ENGINEERING CONSULTANTS, INC.

THE ESTABLISHMENT OF THE PROPERTY LINES AND EXISTING RIGHT OF WAY LINES SHOWN ON THIS PLAN AS OF THIS DATE WAS PERFORMED BY ME OR UNDER MY DIRECT SUPERVISION.

BY: STEVEN L. LAMPHEAR DATE: _____
 PROFESSIONAL REGISTERED SURVEYOR NO. 7876

BASIS OF BEARINGS:
 BEARINGS ARE BASED ON THE RIGHT-OF-WAY LINE OF ROCKBRIDGE B ROAD (A.K.A. MILL STREET) AS SHOWN UPON THE "PLAT OF WILLIAM HULL'S ADDITION TO MILLVILLE" (NOW ROCKBRIDGE) OF RECORD IN VILLAGE PLAT BOOK 1, PAGE 68 IN THE RECORDERS OFFICE, HOCKING COUNTY, OHIO.

RECEIVED _____	20
RECORDED _____	20
BOOK _____	PAGE _____

COUNTY RECORDER



SCALE IN FEET
 0 50 100

P.L.D. NO. **22433**

R/W DESIGNER: SLL
 R/W REVIEWER: WAA

CENTERLINE PLAT

HOC - C.R. 118 - 0.14

1/5

Drawing: P:\PROJECTS\56460\ROW_56460C1.DWG