

D.C. 1°15'
R. 4584
TAN 220.49
L.C. 440.0
CURVE No. 5

D.C. 0°30'
R. 11460
TAN 51.60
L.C. 10340
CURVE No. 6

D.C. 3°30'
R. 1627.14
TAN 57.64
L.C. 115.24
CURVE No. 7

D.C. 10°
R. 573
TAN 114.67
L.C. 111.67
CURVE No. 8

D.C. 3°
R. 1910
TAN 46.68
L.C. 93.40
CURVE No. 9

DATE _____ BY _____

SURVEYED _____
PLOTTED _____
ALIGNMENT CHECKED _____
RT. OF WAY CHECKED _____

PLAN
NOTE BOOK NO. _____

DATE _____ BY _____

SURVEYED _____
PLOTTED _____
B.M.'S NOTED _____
STRUCTURE NOTATIONS SHOWN _____

PROFILE
NOTE BOOK NO. _____

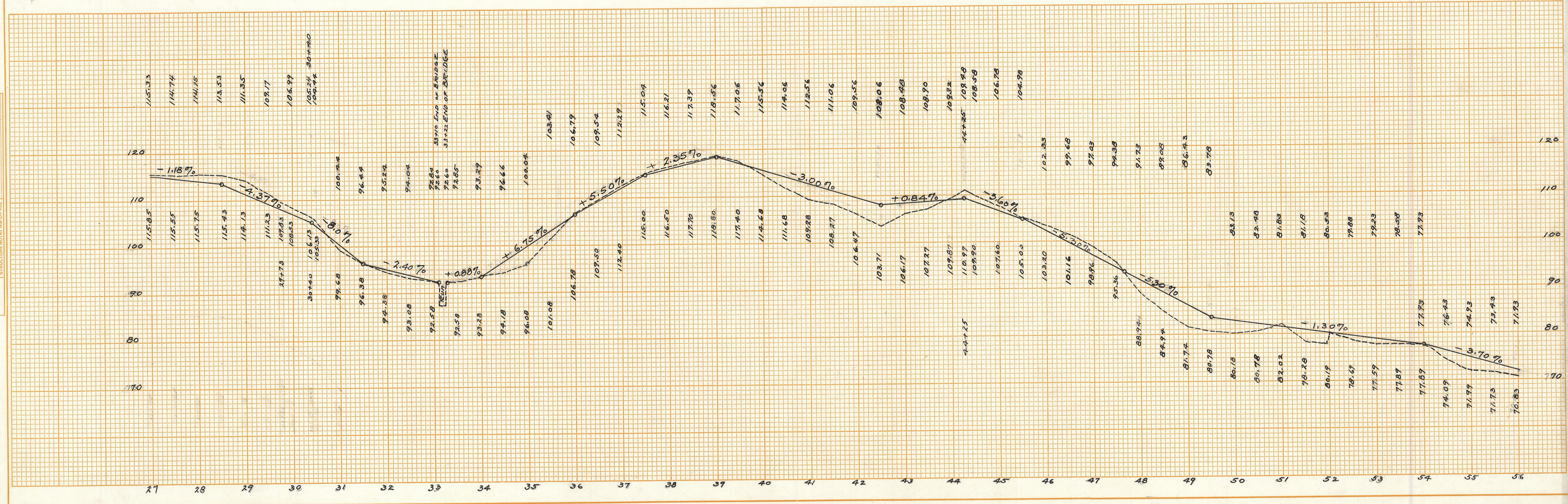

HIGHWAY PLAN - PROFILE PLATE 1
THE H. COLE CO., COLUMBUS, OHIO