

Fed. Aid Dist. No.	State	Fed. Aid Proj. No.	Fiscal Year
10	Ohio		1932

5
B

S.H. 360 - Sec. D, Hocking County, PROPOSAL No. 1

DATE	
BY	
SURVEYED	
PLOTTED	
NOTE BOOK ALIGNED CHECKED	
RT. OF WAY CHECKED	
NO.	

DATE	
BY	
SURVEYED	
PLOTTED	
NOTE BOOK GRADES CHECKED	
BY M.S. NOTED	
STANDARD NOTATION CHKD	
NO.	

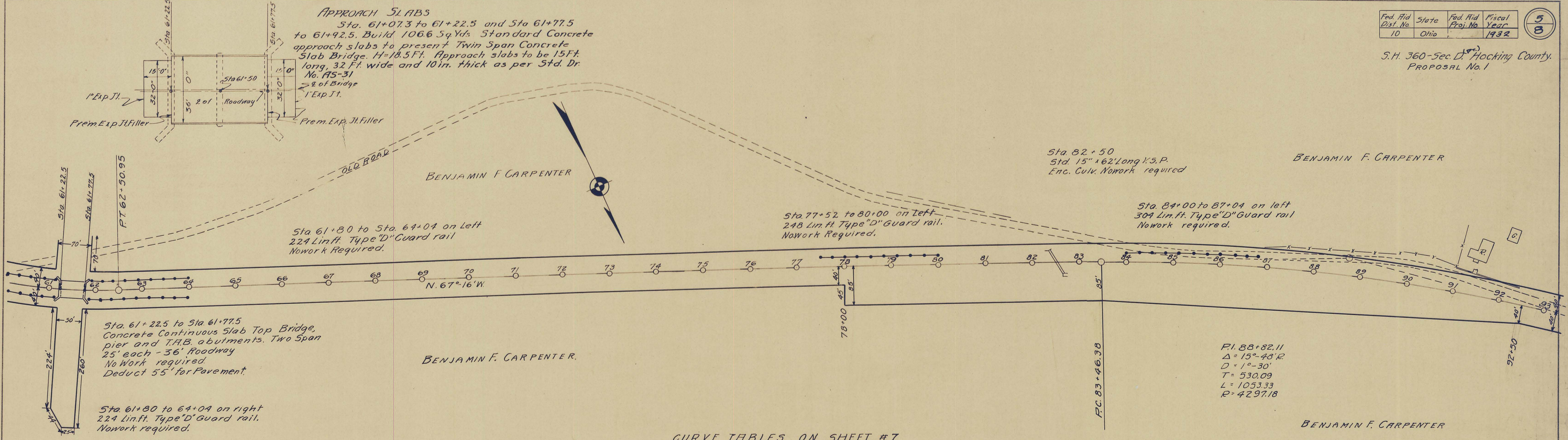

CURVE TABLES ON SHEET # 7

B.M. Sta. 61+50
Bronze Plate in S.E. Cor. of Bridge
Elev. 734.18

B.M. Sta. 79+00
Nail in Sycamore Tree on River Bank
Elev. 732.00

B.M. Sta. 82+50
+ on S.E. Corn. Hillside Culv. H.W.
Elev. 748.58

Elevations Refer To U.S.G.S. Datum.

