

FOR CURB DATA
 SEE SHEET NO. 12

PRESENT BRICK PAVEMENT
 REMOVED & DISPOSED OF

From Sta.	To Sta.	18" Normal thickness Brick Pavement Sq. Yds.	20" Concrete Base Sq. Yds.	18" Brick Surface Course Sq. Yds.
150+00	155+00	646.67		
178+05			555.55	527.77
Total		646.67	555.55	527.77

TREES OVER 8" IN
 DIAMETER REMOVED
 AND DISPOSED OF

From Sta.	To Sta.	Rt. or Lt.	No. of Trees Removed
152+75	153+50	Rt.	2
155+23	155+50	Rt.	1
157+00	158+50	Rt.	6
169+75	170+00	Rt.	15
169+75	170+00	Lt.	3
Total			33

FedAid State of Ohio
 Dist. No. 10 Proj. No. 397-I
 FedAid Fiscal Year 1938
 397-D Rec. Unit

S.H. 360 Sec. K pt. L & Drain
 Hocking County

PAVED GUTTER

Item No.	From Sta.	To Sta.	Rt. or Lt.	Width	Length
1-5	150+00	150+95	Lt.	4'-6"	95.0
2-3	150+00	151+05	Rt.	4'-6"	105.5
3-5	151+06	153+05	Rt.	4'-6"	201.0
4-3	155+25	156+35	Rt.	4'-6"	349.0
5-3	178+92	180+00	Lt.	4'-6"	107.5
6-3	178+92	180+00	Rt.	4'-6"	107.5
7-5	152+00		Rt.	4'-0"	12.0
Total					930.0

PIPE FOR ROADWAY DRAINAGE
 including Full Aggregate Backfill

Item No.	From Sta.	To Sta.	Rt. or Lt.	Lin. Ft. of Drain
1-D	150+00	150+50	Lt.	50
2-D	150+00	151+04	Rt.	104
3-D	151+06	153+08	Rt.	202
4-D	155+24	158+74	Rt.	348
5-D	158+76	160+48	Rt.	176
6-D	160+50	161+82	Rt.	134
7-D	161+84	163+80	Rt.	200
8-D	178+92	180+00	Rt.	108
9-D	178+92	180+00	Lt.	108
Total				1788

*Corrections made for slopes & angles.

PI. 157+82.30
 $\Delta = 13^{\circ} 24' R$
 $D = 2^{\circ} 0'$
 $L = 670.0'$
 $E = 19.7$
 $R = 2064.75'$
 $T = 336.54'$

PI. 0+82.12 Side Road
 $\Delta = 45^{\circ} 0' R$
 $D = 60'$
 $T = 39.56$
 $L = 75.00$
 $PC = 0+48.56$
 $PT = 1+17.56$

PI. 2+95.85 Side Road
 $\Delta = 22^{\circ} 0' L$

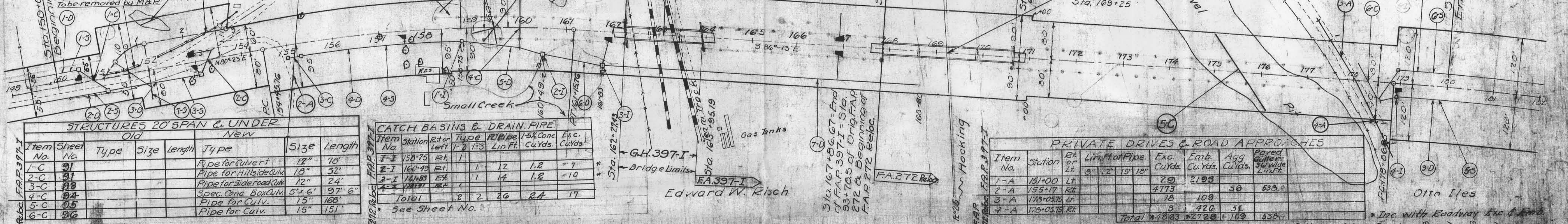

STRUCTURES 20' SPAN & UNDER

Item No.	Sheet No.	Type	Size	Length	Type	Size	Length
1-C	31	Pipe for Culvert	12"	78'			
2-C	31	Pipe for roadside Culv.	15"	52'			
3-C	31	Pipe for roadside Culv.	12"	24'			
4-C	34	Spec. Conc. Box Culv.	5' x 6'	97'-6"			
5-C	35	Pipe for Culv.	15"	168'			
6-C	36	Pipe for Culv.	15"	151'			

CATCH BASINS & DRAIN PIPE

Item No.	Station	Rt. or Lt.	Type	12" Pipe Lin. Ft.	15" Conc. Cuyds.	Exc. Cuyds.
1-I	158+75	Rt.	1	1	1.2	7
2-I	160+48	Rt.	1	12	1.2	10
3-I	161+83	Rt.	1	14	1.2	10
4-I	178+92	Rt.	1	1	1.2	10
Total			4	26	2.4	17

PRIVATE DRIVES & ROAD APPROACHES

Item No.	Station	Rt. or Lt.	Limit of Pipe	Exc. Cuyds.	Emb. Cuyds.	Agg. Cuyds.	Paved Surface Lin. Ft.
1-A	151+00	Lt.		29	2193		
2-A	155+17	Rt.		4773			
3-A	178+05.75	Lt.		18	109		
4-A	178+05.75	Rt.		3	420		
Total				4883	2722	109	538.4

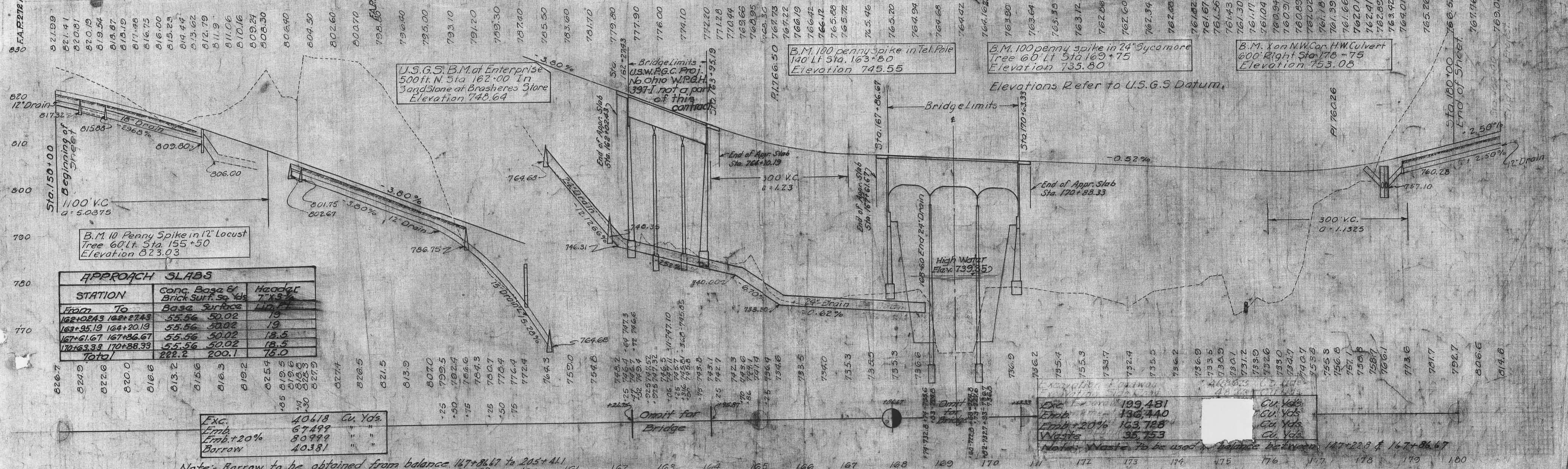

APPROACH SLABS

STATION	Conc. Base & Brick Surf. Sq. Yds.	Headst. 14" Ft.
From		
To		
162+02.43	162+27.43	55.56
163+95.19	164+20.19	55.56
167+61.67	167+86.67	55.56
170+63.33	170+88.33	55.56
Total	222.2	200.1

Exc. 40618 Cu. Yds.
 Emb. 67499 " "
 Emb. +20% 80999 " "
 Borrow 40381 " "

Exc. 199481 Cu. Yds.
 Emb. 136440 " "
 Emb. +20% 163728 " "
 Waste 35753 " "

Note: Waste to be used in balance between 147+22.8 & 167+86.67

Note: Borrow to be obtained from balance 167+86.67 to 205+411