

S.H. 360 Sec. K (pt),
 Hocking County

STATE OF OHIO

DEPARTMENT OF HIGHWAYS

LOGAN-LANCASTER ROAD

HOCKING COUNTY

S.H. NO. 360 SEC. K PT.

FALLS TOWNSHIP

The Standard Specifications of the STATE OF OHIO, Department of Highways, including changes and Supplemental Specifications listed in the proposal will govern this improvement.

I hereby approve these plans and declare that the making of this improvement will not require that the highway be closed to traffic. The right of way necessary for this improvement will be provided by the State of Ohio.

CONVENTIONAL	SIGNS
State Line	-----
County Line	-----
Township Line	-----
Section Line	-----
Center Line	-----
Property Line	-----
City or Village Line	-----
Fence Line	x x x x
Pole Line	o o o o o o
Steam Railroad	=====
Electric Railroad	+++++
Guard Rail
Drain Pipe-New	-----
Drain Pipe-Old	-----

NET LENGTH OF PROJECT 654 LIN. FT. OR 0.123 MI.

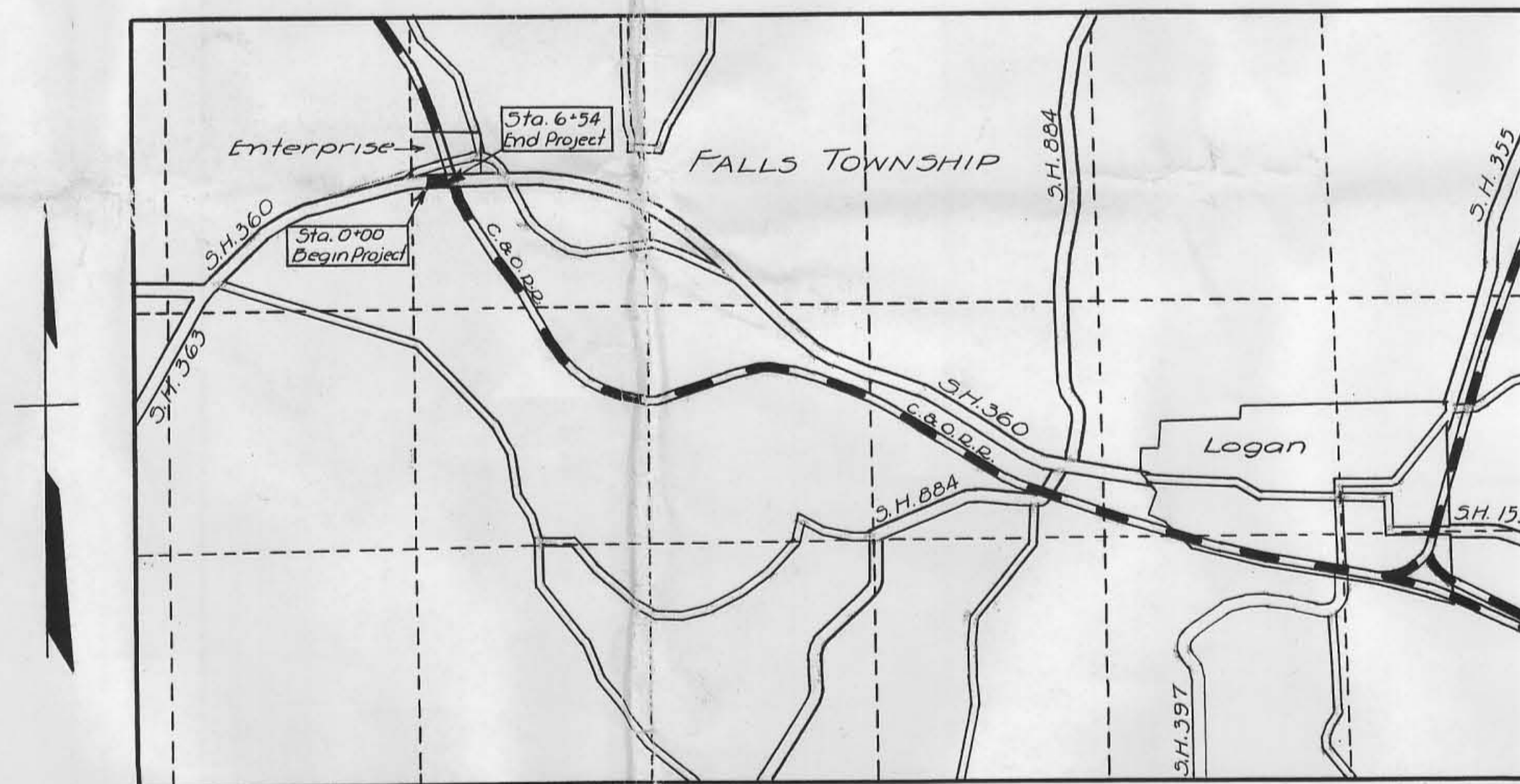

INDEX OF SHEETS	
Title Page	Page - 1
Plan and Profile	Page - 2
Structural Plans	Page - 3
Concrete Gutters	Page - 4
Summary	Page - 2

Supplemental Prints of Standard Construction Drawings	
Drawing No.	Revision
T-8 I No. 1	1-1-36
T-8 CB, 12 & 22	11-12-35
T-1, 2, 3, 4 & 5	1-1-36

LOCATION PLAN

Scale of Miles

Portion to be improved

State Highways

County Roads

SCALES

Plan 1" = 20'

Profile Vertical 1" = 10'

Profile Horizontal 1" = 20'



Approved B. W. Wright
 Date 12-8-38 Resident District Deputy Director

Approved J. M. Verhart
 Date 12-9-38 Resident Division Deputy Director

Approved R. W. ...
 Date 12/10/38 Chief Engineer Location & Design

Approved _____
 Date _____ Chief Engineer Bureau of Maintenance

Approved _____
 Date _____ Chief Engineer Bureau of Bridges

Approved Archibald ...
 Date 12/12-38 First Assistant Director and Chief Engineer

Approved J. D. ...
 Date 12/14-38 Director of Highways

Recommended for Approval _____
 Date _____ District Engineer Bureau of Public Roads

Recommended for Approval _____
 Date _____ Chief Engineer Bureau of Public Roads

Approved _____
 Date _____ Chief of Bureau

File 300