

HOCKING COUNTY, STARR TOWNSHIP
SECTION 20, T.12N, R.16W

Curve Data

P.I. = Sta. 142+83.77
D = 36° 31' 01" (LT)
Dc = 10° 03' 07"
R = 570.00'
T = 188.05'
L = 363.28'
E = 30.22'
C = 357.17'
C.B. = N 33° 35' 43" E

CSX Trans. Inc.
O.R. 181, Pg. 998

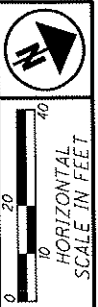

PID NO. 25094
R/W DESIGNER P.L.H.
R/W REVIEWER R.F.R.

I:\project\HOC-328-2.74\25094\row\sheet\25094RD001.dgn 23-AUG-2011 8:57AM gwright

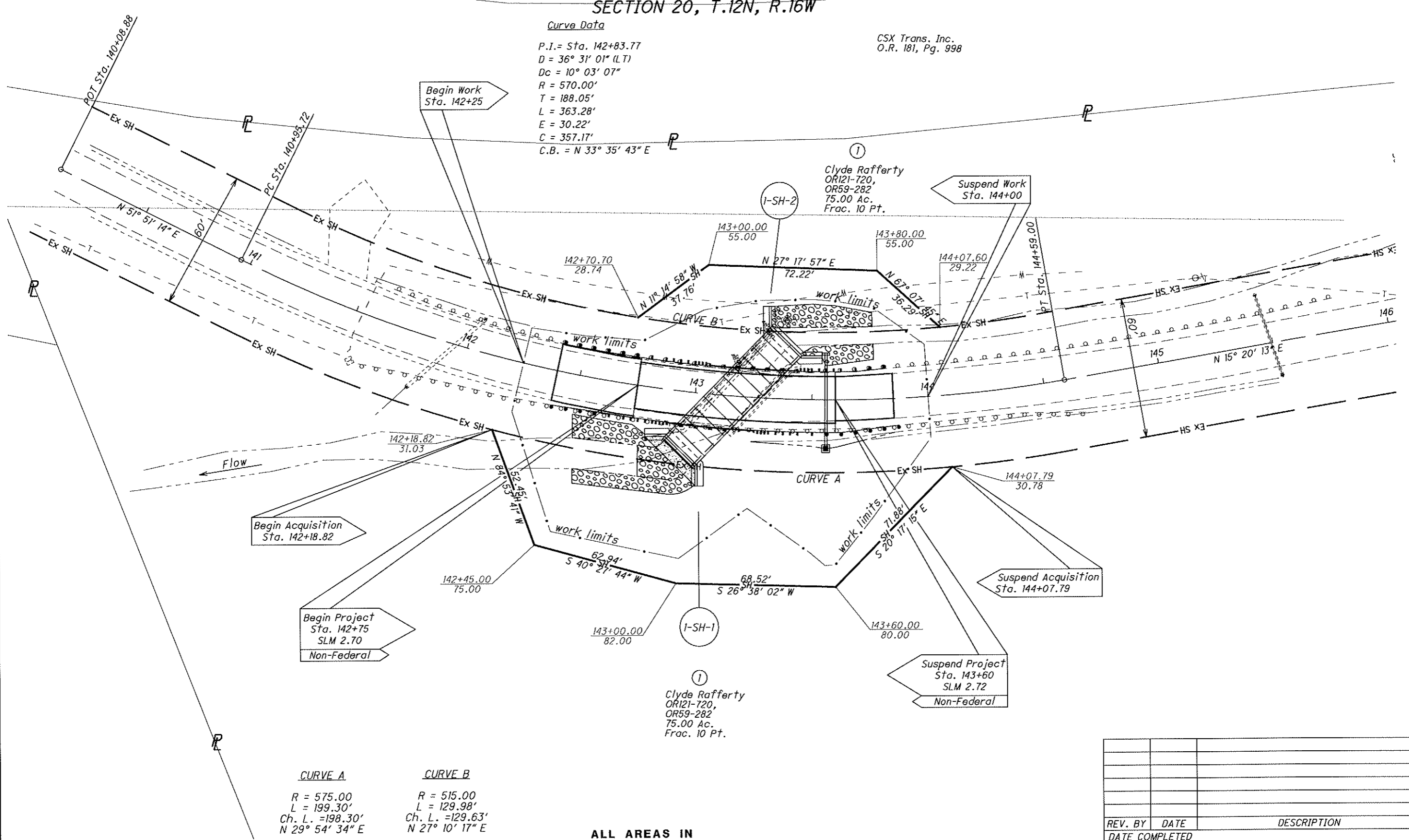

Begin Acquisition
Sta. 142+18.82

Begin Project
Sta. 142+75
SLM 2.70
Non-Federal

Suspend Acquisition
Sta. 144+07.79

Suspend Project
Sta. 143+60
SLM 2.72
Non-Federal

CURVE A
R = 575.00
L = 199.30'
Ch. L. = 198.30'
N 29° 54' 34" E

CURVE B
R = 515.00
L = 129.98'
Ch. L. = 129.63'
N 27° 10' 17" E

ALL AREAS IN

REV. BY	DATE	DESCRIPTION

PARCEL NO.	OWNER	SHEET NO.	OWNERS RECORD		AUDITOR'S PARCEL	RECORD AREA	TOTAL P.R.O.	GROSS TAKE	P.R.O. IN TAKE	NET TAKE	STRUC-TURE	NET RESIDUE		TYPE FUND	REMARKS	AS ACQUIRED	
			BOOK	PAGE								LEFT	RIGHT			BOOK	PAGE
I-SH-1	Clyde Rafferty	OR121	720		160003000000	75.00 Ac.	1.675Ac.	0.181Ac.	0.000Ac.	0.181Ac.		2.217Ac.	70.865Ac.				
I-SH-2		OR59	282					0.062Ac.	0.000Ac.	0.062Ac.							

RIGHT OF WAY PLAN

HOC-328-2.70