

# HOCKING COUNTY SECTION 13 T11N R18W BENTON TOWNSHIP

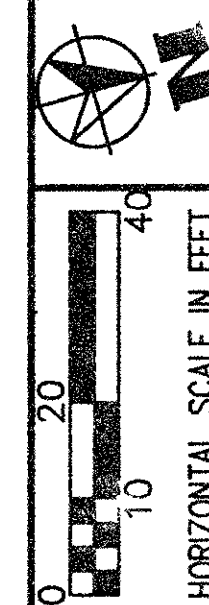

## LEGEND

- PAVEMENT REMOVED
- REFERENCE MONUMENT SET
- TREE TO BE REMOVED

NOTE: TREES SHALL NOT BE DISTURBED UNLESS DESIGNATED FOR REMOVAL.

STATE OF OHIO

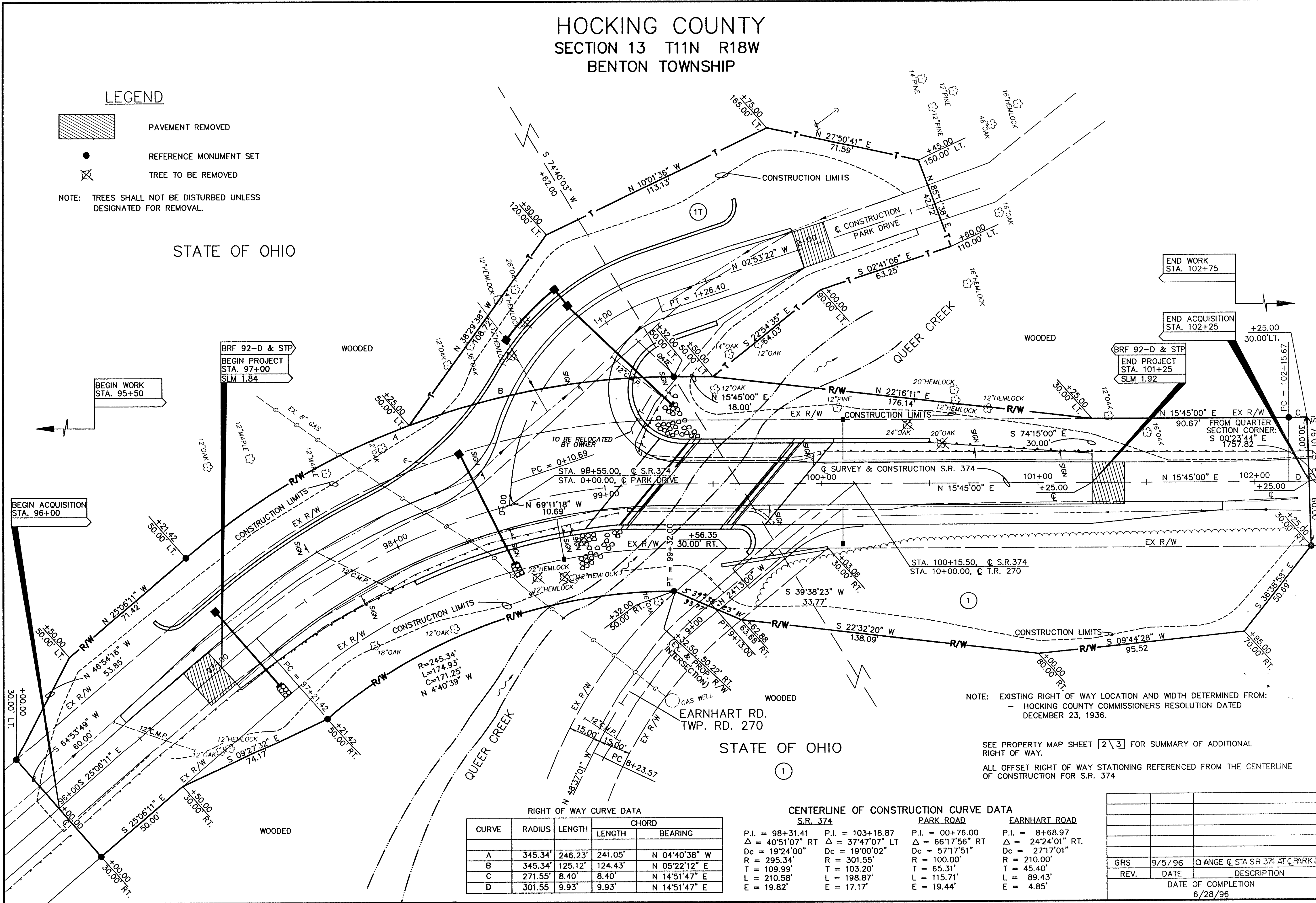

FEDERAL PROJECT NO.  
BRF 92-D  
STP

STATE JOB NO.  
109290

RIGHT OF WAY PLAN  
STA 96+00 TO STA 102+25

HOC-374-01.84

3 / 3

49  
49

RIGHT OF WAY CURVE DATA

CURVE	RADIUS	LENGTH	CHORD	
			LENGTH	BEARING
A	345.34'	246.23'	241.05'	N 04°40'38" W
B	345.34'	125.12'	124.43'	N 05°22'12" E
C	271.55'	8.40'	8.40'	N 14°51'47" E
D	301.55'	9.93'	9.93'	N 14°51'47" E

CENTERLINE OF CONSTRUCTION CURVE DATA

S.R. 374		PARK ROAD		EARNHART ROAD	
P.I. = 98+31.41	P.I. = 103+18.87	P.I. = 00+76.00	P.I. = 8+68.97		
Δ = 40°51'07" RT	Δ = 37°47'07" LT	Δ = 66°17'56" RT	Δ = 24°24'01" RT.		
Dc = 19°24'00"	Dc = 19°00'02"	Dc = 57°17'51"	Dc = 27°17'01"		
R = 295.34'	R = 301.55'	R = 100.00'	R = 210.00'		
T = 109.99'	T = 103.20'	T = 65.31'	T = 45.40'		
L = 210.58'	L = 198.87'	L = 115.71'	L = 89.43'		
E = 19.82'	E = 17.17'	E = 19.44'	E = 4.85'		

NOTE: EXISTING RIGHT OF WAY LOCATION AND WIDTH DETERMINED FROM:  
- HOCKING COUNTY COMMISSIONERS RESOLUTION DATED DECEMBER 23, 1936.

SEE PROPERTY MAP SHEET 23 FOR SUMMARY OF ADDITIONAL RIGHT OF WAY.

ALL OFFSET RIGHT OF WAY STATIONING REFERENCED FROM THE CENTERLINE OF CONSTRUCTION FOR S.R. 374

REV.	DATE	DESCRIPTION
GRS	9/5/96	CHANGE Q STA SR 374 AT Q PARK DR
		DATE OF COMPLETION 6/28/96