

HOC-374-40.054(24.89)

SECTION 23 & 26, T.13N., R.18W.
GOOD HOPE TOWNSHIP
HOCKING COUNTY

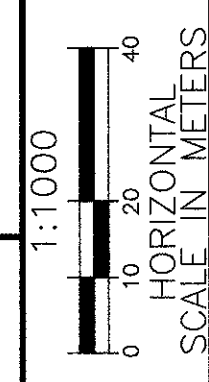
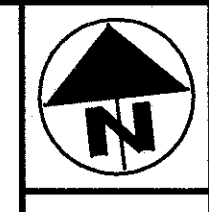

P.L.D. NO. 12851

CENTERLINE PLAT

HOC-374-40.054(24.89)

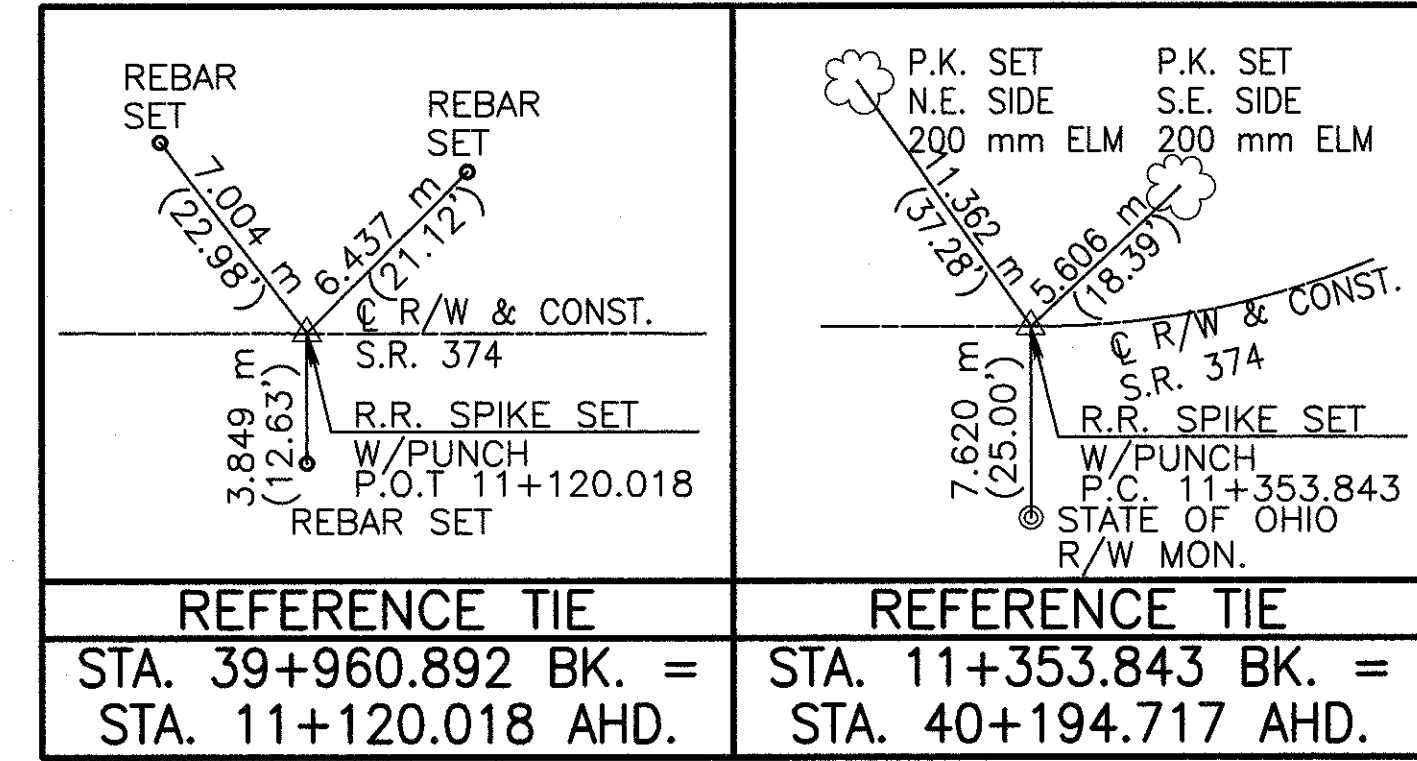

RECORD CURVE DATA
P.I. STA. 40+228.775
 $\Delta = 51^{\circ}59'00''$ LT.
T=34.058 m (111.74')
R=69.854 m (229.18')
L=63.377 m (207.93')
E=7.861 m (25.79')
C= 61.225 m (200.87')
CHORD BRG.= N 70°11'34" E

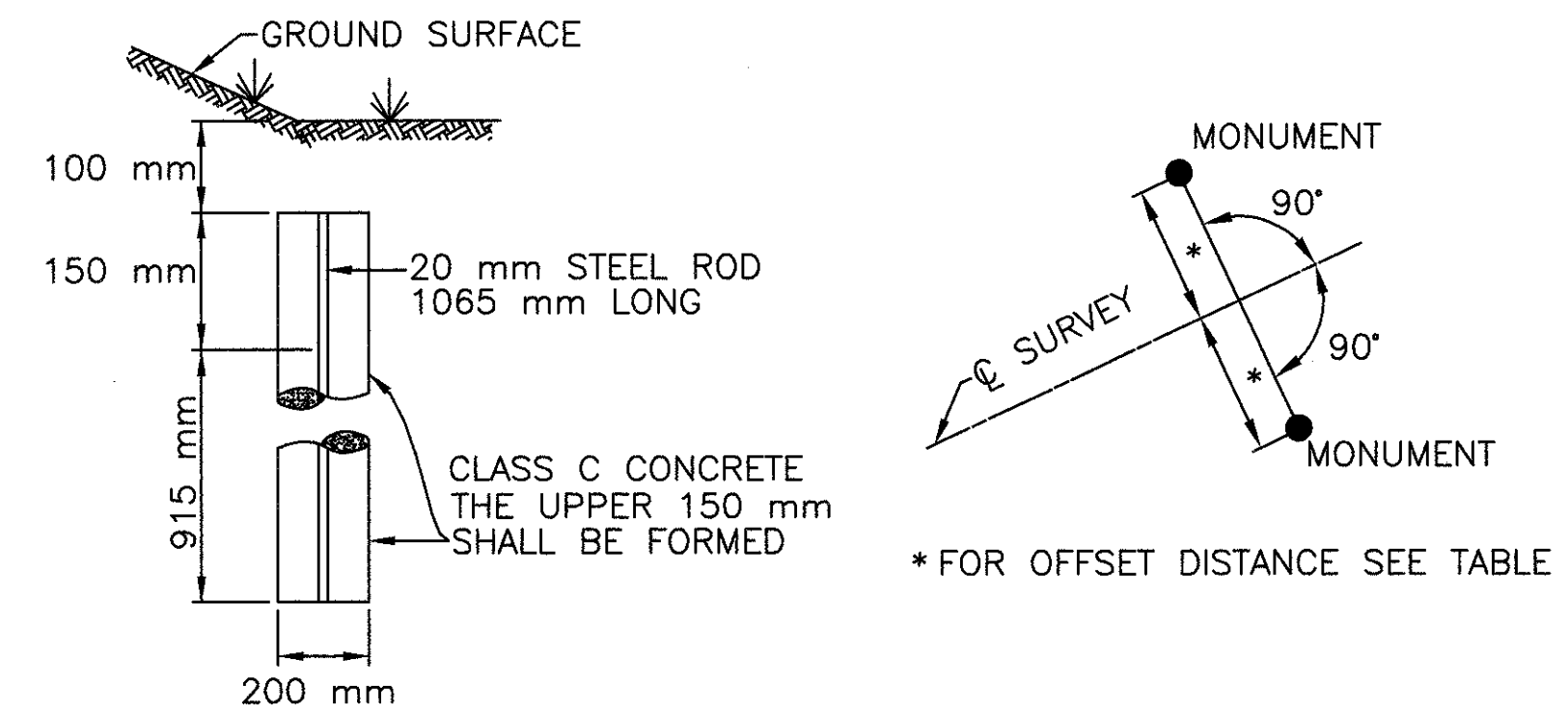

CENTERLINE MONUMENTS AND REFERENCE MONUMENTS ARE SHOWN ON STANDARD CONSTRUCTION DRAWING MC-1 (REV. 6-13-69) OF THE OHIO DEPARTMENT OF TRANSPORTATION. THE PLACING OF THE MONUMENTS SHALL BE UNDER THE DIRECTION OF A REGISTERED PROFESSIONAL SURVEYOR AND ARE TO BE SET, AS SHOWN, BY THE HIGHWAY CONTRACTOR AT THE TIME OF CONSTRUCTION. ANY ALTERATIONS, WITH PRIOR APPROVAL OF THE DEPARTMENT OF TRANSPORTATION, SHALL BE NOTED AND O.D.O.T. SHALL BE NOTIFIED OF THE NEW LOCATION.

BASIS OF BEARING

ALL BEARINGS SHOWN ARE FOR PROJECT USE ONLY. THEY ARE BASED ON THE SURVEY DATA PROVIDED BY OHIO DEPARTMENT OF TRANSPORTATION DISTRICT 10.

I HEREBY CERTIFY THAT THIS PLAT IS A TRUE DELINEATION OF A SURVEY MADE FOR THE OHIO DEPARTMENT OF TRANSPORTATION IN 1997 BY McCOY ASSOCIATES INC.

THE ESTABLISHMENT OF THE PROPERTY LINES AND EXISTING RIGHT OF WAY LINES SHOWN ON THIS PLAN AS OF THIS DATE WAS PERFORMED BY ME OR UNDER MY DIRECT SUPERVISION.

BY Bryan E. McCoy SURVEYOR No. 4936
DATE 4-29-98

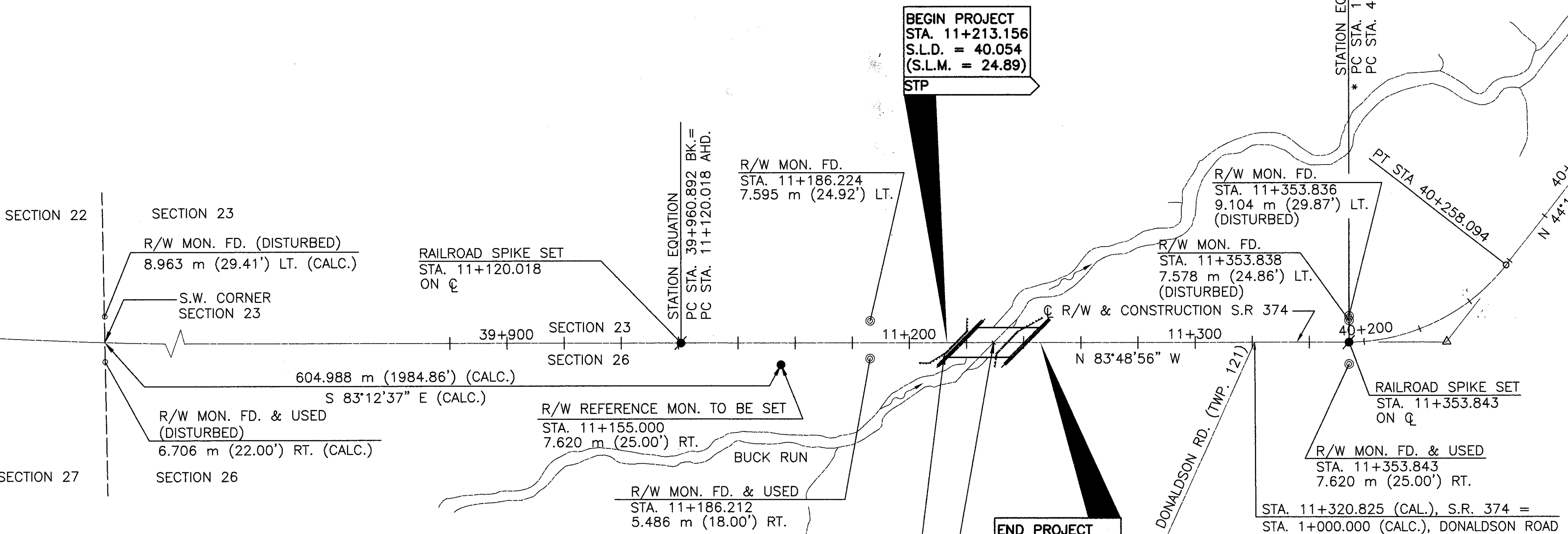
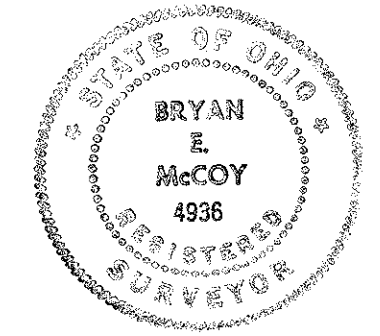

EXISTING RIGHT OF WAY MONUMENTS FOUND					
OBSERVED STATION (METRIC)	RECORD STATION (ENGLISH)	OBSERVED DISTANCE FROM ϕ R/W		RECORD DISTANCE FROM ϕ R/W	
		RIGHT	LEFT	RIGHT	LEFT
STA. 11+186.212	STA. 376+00.00	5.486m (18.00')		5.486m (18.00')	
STA. 11+186.224	STA. 376+00.00		7.595m (24.92')		7.620m (25.00')
P.C. STA. 11+353.836	P.C. STA. 372+50.14		9.104m (29.87')		9.144m (30.00')
P.C. STA. 11+353.838	P.C. STA. 372+50.14		7.578m (24.86')		7.620m (25.00')
P.C. STA. 11+353.843	P.C. STA. 372+50.14	7.620m (25.00')		7.620m (25.00')	

NOTE: THE EXISTING R/W WIDTH AND LOCATION WERE DETERMINED USING:
S.R. 374 SEC. 17.94-21.97 (S.H. 842 SEC. D)

STA. 11+212.174, 4.018 m (13.18') RT.
SOUTHWEST CORNER OF EX. BRIDGE AS REFERENCED BY LAND OWNER DEEDS: VOL. 210, PG. 320 VOL. 78, PG. 95

STA. 11+229.504, S.R. 374 = STA. 10+000.000, CHANNEL BASELINE

* STATIONING WAS ESTABLISHED FROM THE FOLLOWING:
PC STA. 11+353.843 BK. (METRIC) = PC STA. 372+50.14 (ENGLISH) (REC.)

- MONUMENT LEGEND**
- ⊙ EXISTING R/W MONUMENT FOUND
 - EXISTING IRON PIN/P.K. NAIL FOUND
 - R.R. SPIKE SET
 - 19mm (3/4") x 0.75m (30") IRON PIN SET WITH I.D. CAP

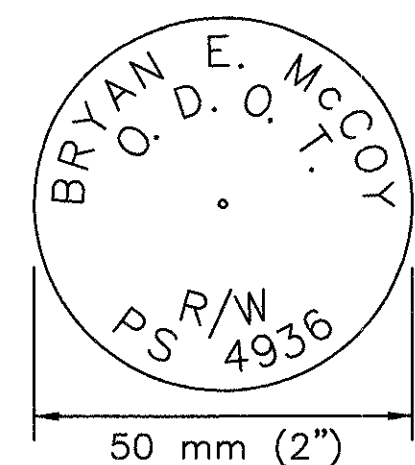

ALUMINUM CAPPED 19 mm (3/4") REBAR IDENTIFIED WITH INSCRIPTION SHOWN ABOVE.

RECORDER'S STAMP

RECEIVED _____, 19____
RECORDED _____, 19____
BOOK _____, PAGE____

COUNTY RECORDER