

CALCULATED BY: C.J.S. DATE: 2-12-74
 CHECKED BY: M.H.L. DATE: 2-15-74

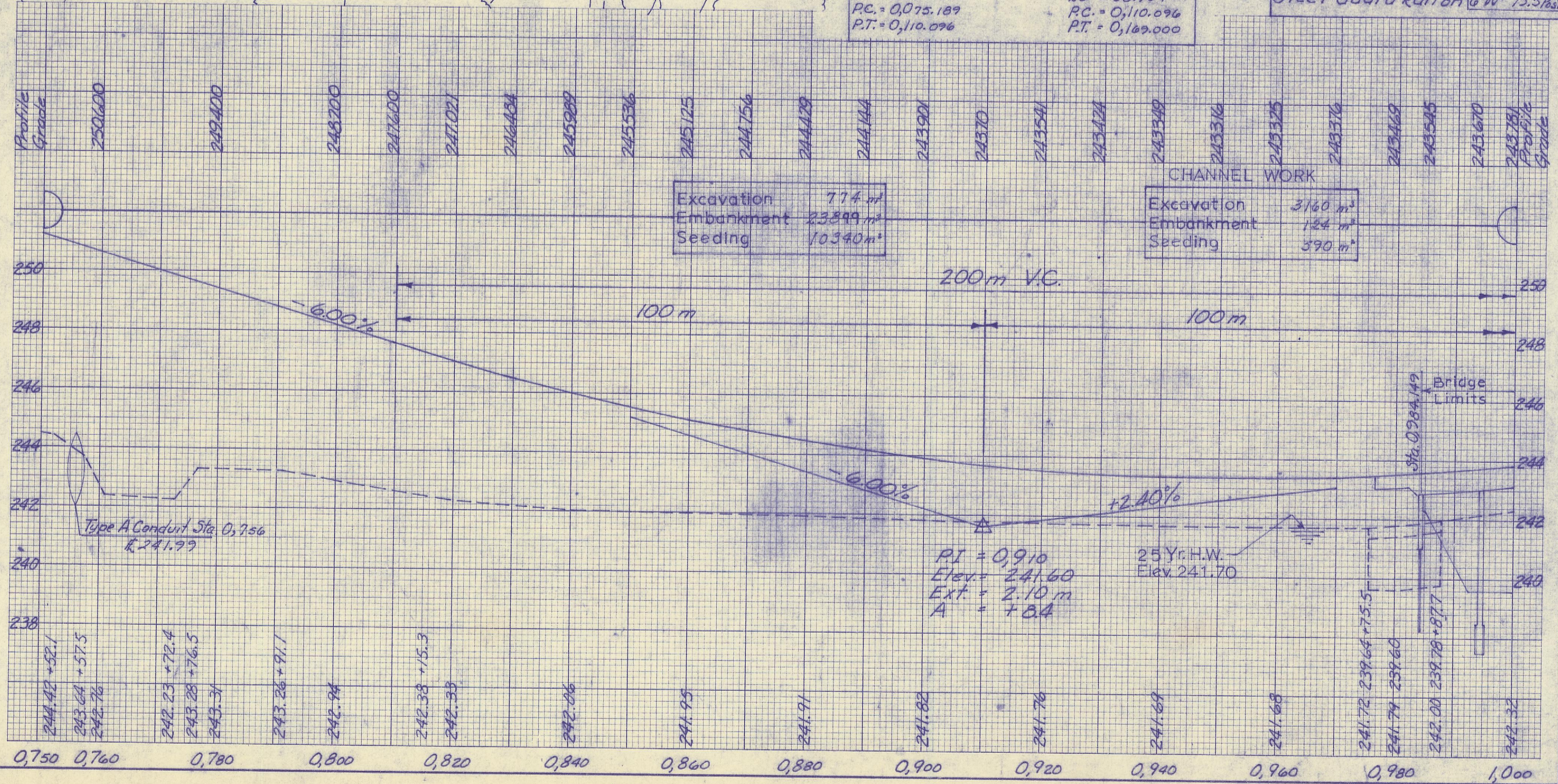
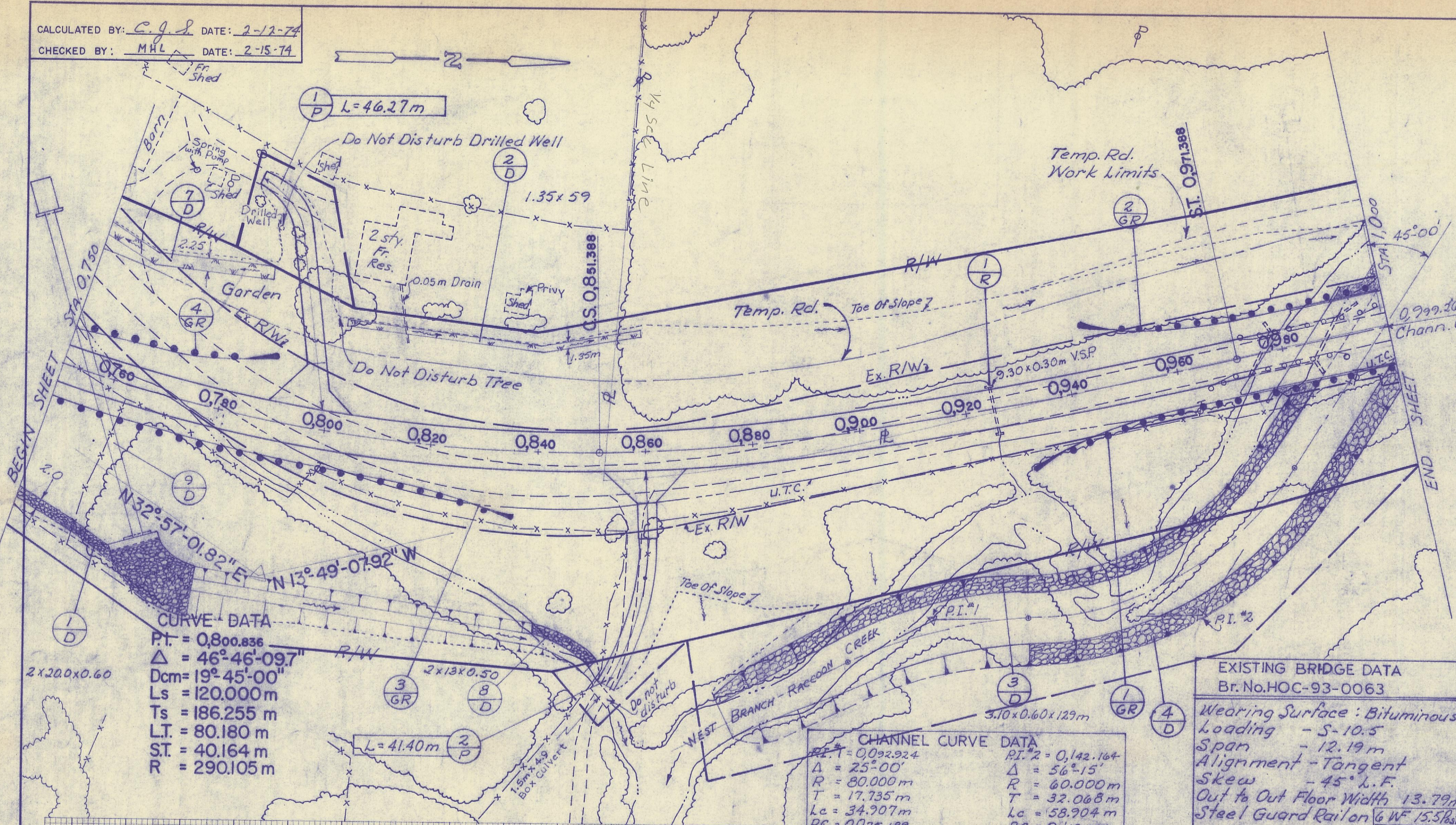

EXISTING BRIDGE DATA
 Br. No. HOC-93-0063
 Wearing Surface: Bituminous
 Loading - S-10.5
 Span - 12.19 m
 Alignment - Tangent
 Skew - 45° L.F.
 Out to Out Floor Width 13.79 m
 Steel Guard Rail on 6 WF 15.5 lbs

CHANNEL CURVE DATA
 PI. #1 = 0.92924
 Δ = 25° 00'
 R = 60.000 m
 T = 17.735 m
 Lc = 34.907 m
 PC = 0.075.189
 PT = 0.110.096
 PI. #2 = 0.142.164
 Δ = 56° 15'
 R = 60.000 m
 T = 32.068 m
 Lc = 58.904 m
 PC = 0.110.096
 PT = 0.169.000

REF. NO.	STATION TO STATION	See Sheet No.	ESTIMATED QUANTITIES	TOTALS
1-GR	ROADWAY 0.930.00 To 0.976.20			
2-GR	0.943.90 To 0.989.50			
3-GR	0.750.00 To 0.835.6			
4-GR	0.750.00 To 0.788.30			
1-R	0.935.40			
1-D	0.750 To 0.768			
2-D	0.81 To 0.860			
3-D	0.050 To 0.206 Chann.			
4-D	0.110 To 0.153 Chann.			
7-D	0.750 To 0.785			
8-D	0.840 To 0.852			
9-D	0.756			
1-P				
2-P				
3-P				
4-P				
5-P				
6-P				
7-P				
8-P				
9-P				
10-P				
11-P				
12-P				
13-P				
14-P				
15-P				
16-P				
17-P				
18-P				
19-P				
20-P				
21-P				
22-P				
23-P				
24-P				
25-P				
26-P				
27-P				
28-P				
29-P				
30-P				
31-P				
32-P				
33-P				
34-P				
35-P				
36-P				
37-P				
38-P				
39-P				
40-P				
41-P				
42-P				
43-P				
44-P				
45-P				
46-P				
47-P				
48-P				
49-P				
50-P				
51-P				
52-P				
53-P				
54-P				
55-P				
56-P				
57-P				
58-P				
59-P				
60-P				
61-P				
62-P				
63-P				
64-P				
65-P				
66-P				
67-P				
68-P				
69-P				
70-P				
71-P				
72-P				
73-P				
74-P				
75-P				
76-P				
77-P				
78-P				
79-P				
80-P				
81-P				
82-P				
83-P				
84-P				
85-P				
86-P				
87-P				
88-P				
89-P				
90-P				
91-P				
92-P				
93-P				
94-P				
95-P				
96-P				
97-P				
98-P				
99-P				
100-P				
TOTALS				

PLAN & PROFILE FROM STA. 0.750 TO STA. 1.000