

$\Delta = 7^{\circ} - 51' - 45''$
 $D_c = 0^{\circ} - 18'$
 $R = 19098.59'$
 $L.T. = 1312.48'$
 $L_c = 2620.83'$
 $E = 45.04'$

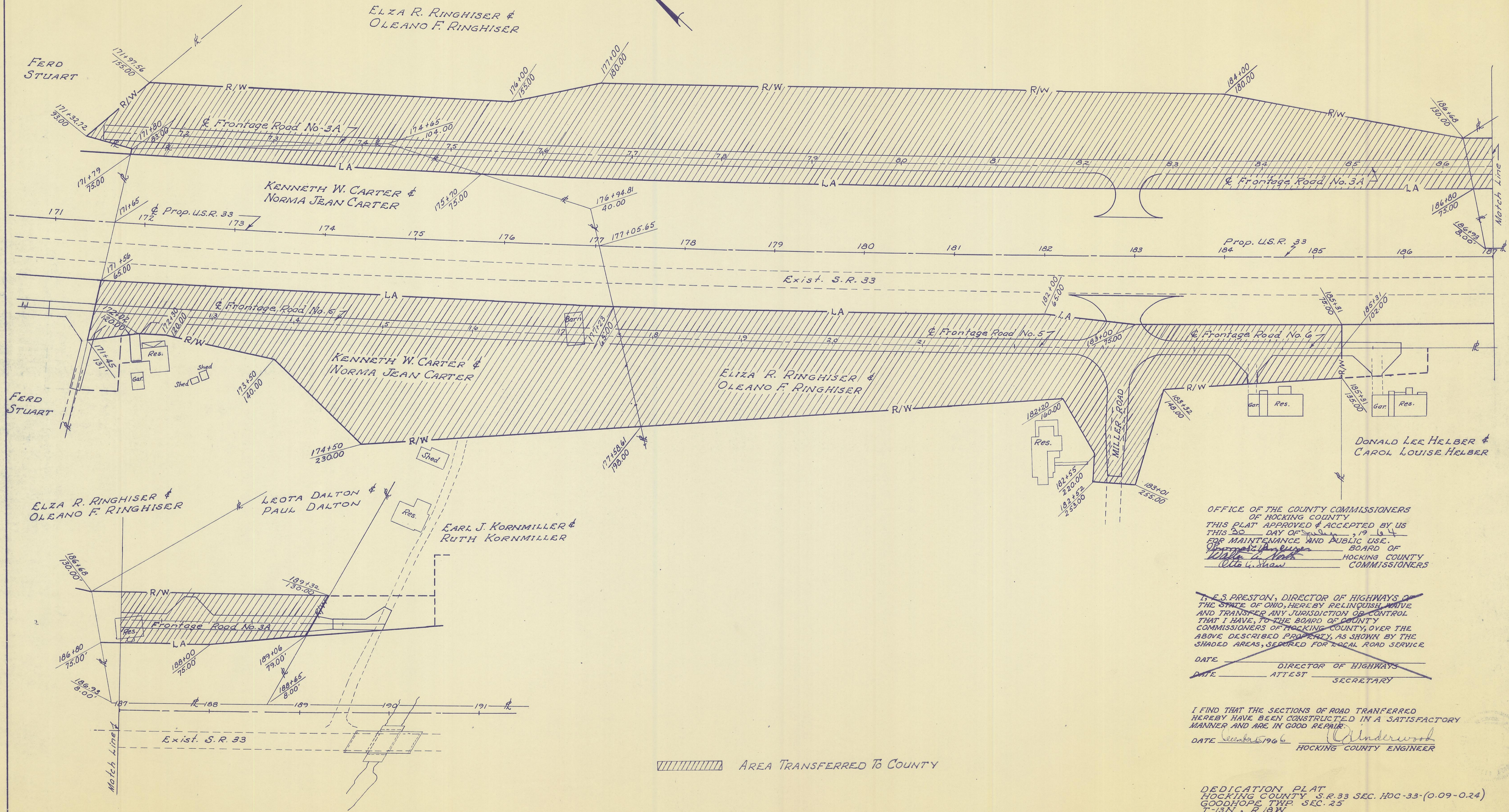

OFFICE OF THE COUNTY COMMISSIONERS
 OF HOCKING COUNTY
 THIS PLAT APPROVED & ACCEPTED BY US
 THIS 30 DAY OF 1966
 FOR MAINTENANCE AND PUBLIC USE.
 BOARD OF COUNTY COMMISSIONERS
 HOCKING COUNTY
 Ohio G. Shaw

~~I, E.S. PRESTON, DIRECTOR OF HIGHWAYS OF THE STATE OF OHIO, HEREBY RELINQUISH, WAIVE AND TRANSFER ANY JURISDICTION OR CONTROL THAT I HAVE, TO THE BOARD OF COUNTY COMMISSIONERS OF HOCKING COUNTY, OVER THE ABOVE DESCRIBED PROPERTY, AS SHOWN BY THE SHADED AREAS, SECURED FOR LOCAL ROAD SERVICE.
 DATE _____ DIRECTOR OF HIGHWAYS
 DATE _____ ATTEST SECRETARY~~

I FIND THAT THE SECTIONS OF ROAD TRANSFERRED HEREBY HAVE BEEN CONSTRUCTED IN A SATISFACTORY MANNER AND ARE IN GOOD REPAIR.
 DATE December 1966 W. Anderson
 HOCKING COUNTY ENGINEER

AREA TRANSFERRED TO COUNTY

DEDICATION PLAT
 HOCKING COUNTY S.R. 33 SEC. HDC-33-(0.09-0.24)
 GODHOPE TWP. SEC. 25
 T-13N, R-18W