

THIS IMPROVEMENT HAS BEEN DECLARED A LIMITED ACCESS HIGHWAY FROM STATION 19+00 TO STATION 225+00 BY ACTION OF THE DIRECTOR OF HIGHWAYS AND RECORDED IN VOLUME 47 PAGE 340 OF THE DIRECTORS JOURNAL PURSUANT TO LAW.

STATIONS AND OFFSETS WITHIN THE LIMITS OF CENTER LINE SURVEY SPIRALS ARE REFERENCED TO THE SPIRAL TANGENTS.

CENTER LINE SURVEY PLAT

LOGAN-LANCASTER ROAD

U.S. ROUTE 33 SEC. 0.09-0.24

HOCKING COUNTY, OHIO

GOOD HOPE TWP. R. 18, T. 13, SEC'S. 23, 26, 25

Received January 4 1963
 Recorded January 4 1963
 Book C Page 59
Esther Carpenter
 County Recorder

CENTER LINE PLAT
 HOC - 33 - 0.09 - 0.24

374

20271

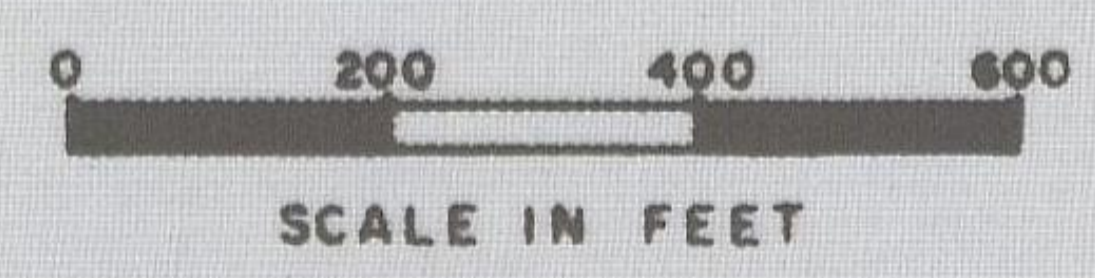

I HEREBY CERTIFY THAT THIS PLAT IS A TRUE DELINEATION OF A SURVEY MADE FOR THE OHIO DEPARTMENT OF HIGHWAYS IN 1962 BY Louis Berger & Associates Orange, New Jersey
 SIGNED Harry C. Schimmel REGISTERED SURVEYOR
 REGISTRATION No. 1183
 DATE December 12-1962

CURVE DATA
RELOC. S.R. 796

PI =	2+62.07
Δ =	60°-10'-16"
D =	38'-11'-50"
R =	180.00'
T =	86.90'
L =	157.83'

§ SURVEY CURVE DATA

PI =	148+92.55
Δ =	31°-45'
D =	2°-20'
Ls =	300.00'
Ts =	848.73'
Os =	3°-30'
Lc =	1060.71'
Lt =	200.04'
St =	100.04'

§ SURVEY CURVE DATA

PI =	116+68.83
Δ =	60°-19'
D =	1°-20'
R =	4297.18'
T =	2496.84'
L =	4523.75'

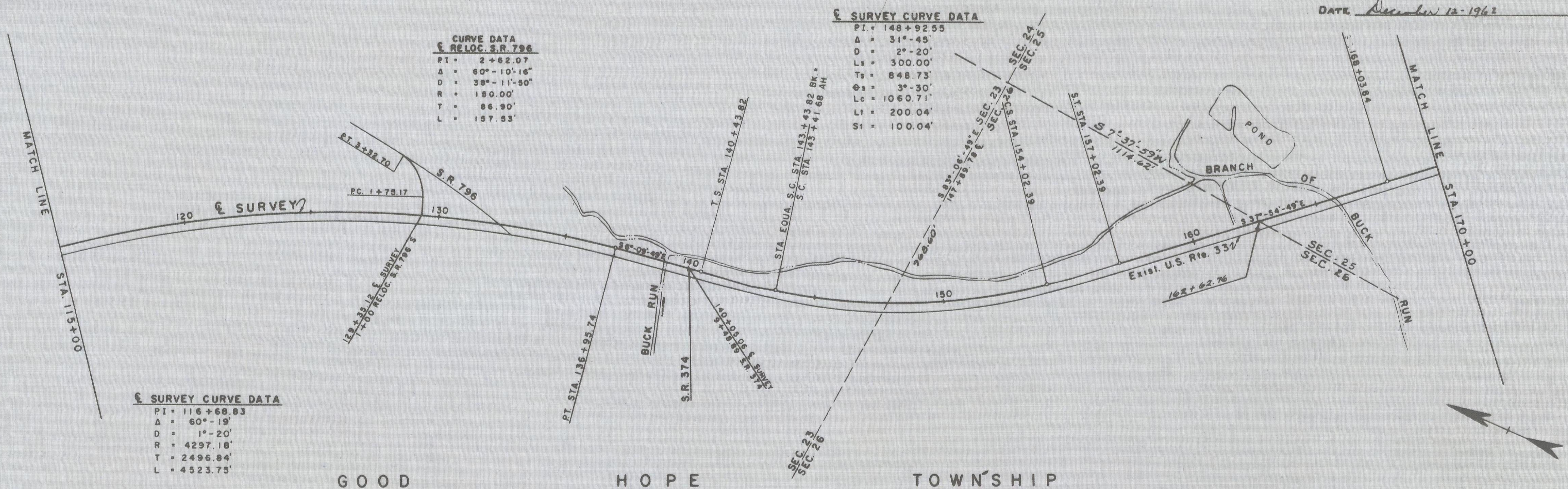

REFERENCE MONUMENTS WILL BE SET ON THE CENTERLINE AT THE FOLLOWING STATIONS AFTER CONSTRUCTION

P.O.C. 120+00	T.S. 140+43.82	S.T. 157+02.39
P.O.C. 125+00	S.C. 143+43.82 BK.	P.O.T. 160+00
P.O.C. 132+00	S.C. 143+41.68 AHD	P.C. 168+03.84
P.T. 136+95.74	C.S. 157+02.39	

3