

STATION IN FEET	GRADE & VERT. CURVES	CUT (-) FILL (+)	PROPOSED ELEVATION	EXISTING ELEVATION
6+16	0' @ 11.7%	-2.40	939.20	941.8
6+00	4 1/2' VC	-0.90	938.22	939.2
5+75		-1.16	935.44	936.6
5+50		-2.00	931.90	933.9
5+00	235' @ 4.19%	-2.30	924.80	927.1
4+50		-0.19	917.71	917.9
4+00		+1.72	910.62	908.9
3+50		+3.52	903.52	900.0
3+40		+2.90	902.10	899.2
3+00	100' VC	+0.99	896.79	895.8
2+90		+0.78	895.58	894.8
2+50		+2.39	891.19	888.8
2+40		+2.01	890.21	889.2
2+00		+0.67	886.37	885.7
1+50	210' @ 9.55%	-0.52	881.58	882.1
1+00		-0.91	876.77	877.7
0+50		0.00	872.00	872.0
0+30	20' VC	+0.59	870.09	869.5
0+20		+1.36	869.76	868.1
0+10		0.00	869.50	869.5
0+00	0' @ 11.7%	0.00	869.7	869.7

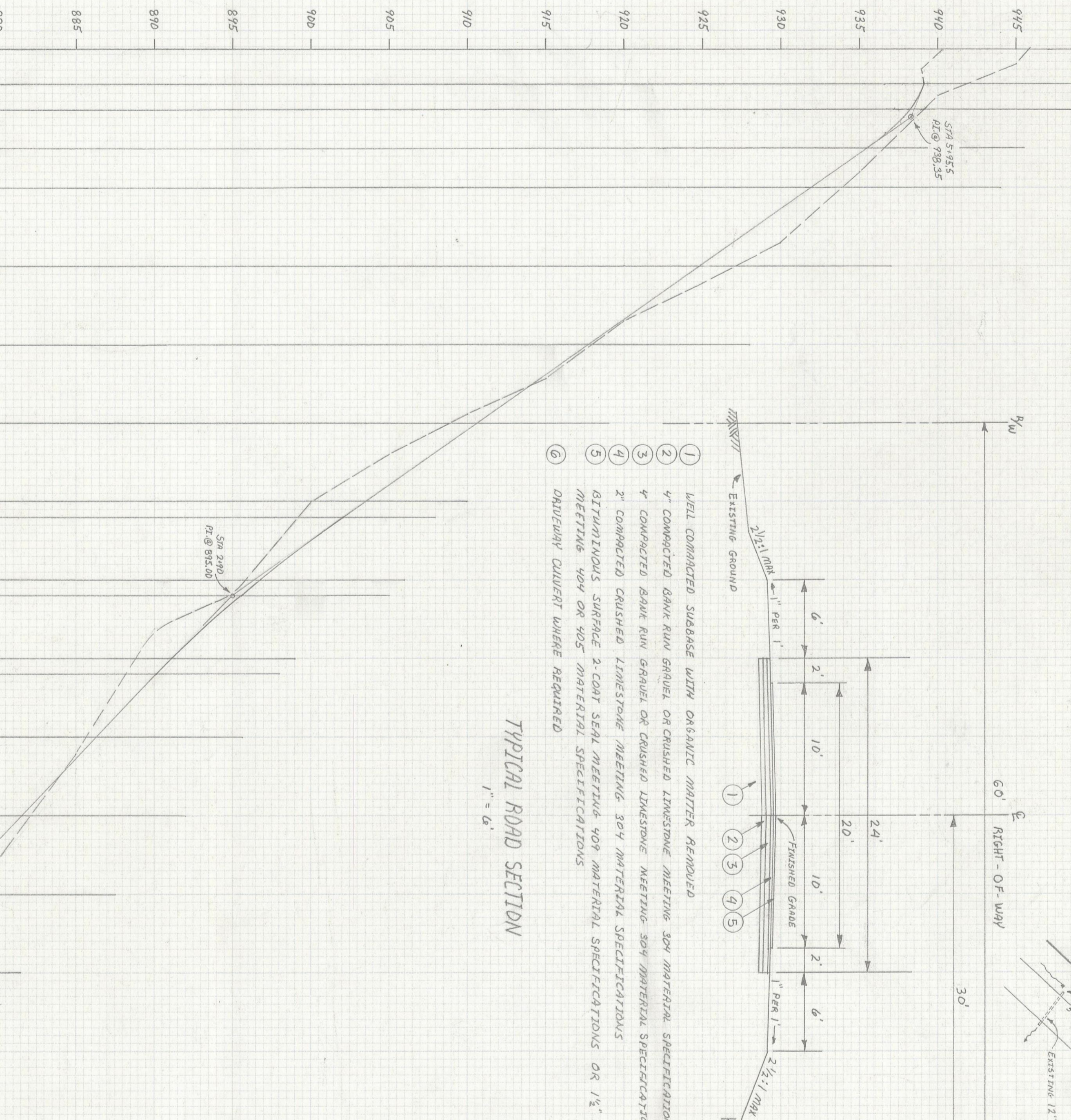

TYPICAL ROAD SECTION
1" = 6'

- 1 WELL COMPACTED SUBBASE WITH ORGANIC MATTER REMOVED
- 2 1/4" COMPACTED BANK RUN GRAVEL OR CRUSHED LIMESTONE MEETING 304 MATERIAL SPECIFICATIONS
- 3 1/4" COMPACTED BANK RUN GRAVEL OR CRUSHED LIMESTONE MEETING 304 MATERIAL SPECIFICATIONS
- 4 2" COMPACTED CRUSHED LIMESTONE MEETING 304 MATERIAL SPECIFICATIONS
- 5 BITUMINOUS SURFACE 2-COAT SEAL MEETING 409 MATERIAL SPECIFICATIONS OR 1 1/2" ASPHALT MEETING 404 OR 405 MATERIAL SPECIFICATIONS
- 6 DRAINWAY CULVERT WHERE REQUIRED

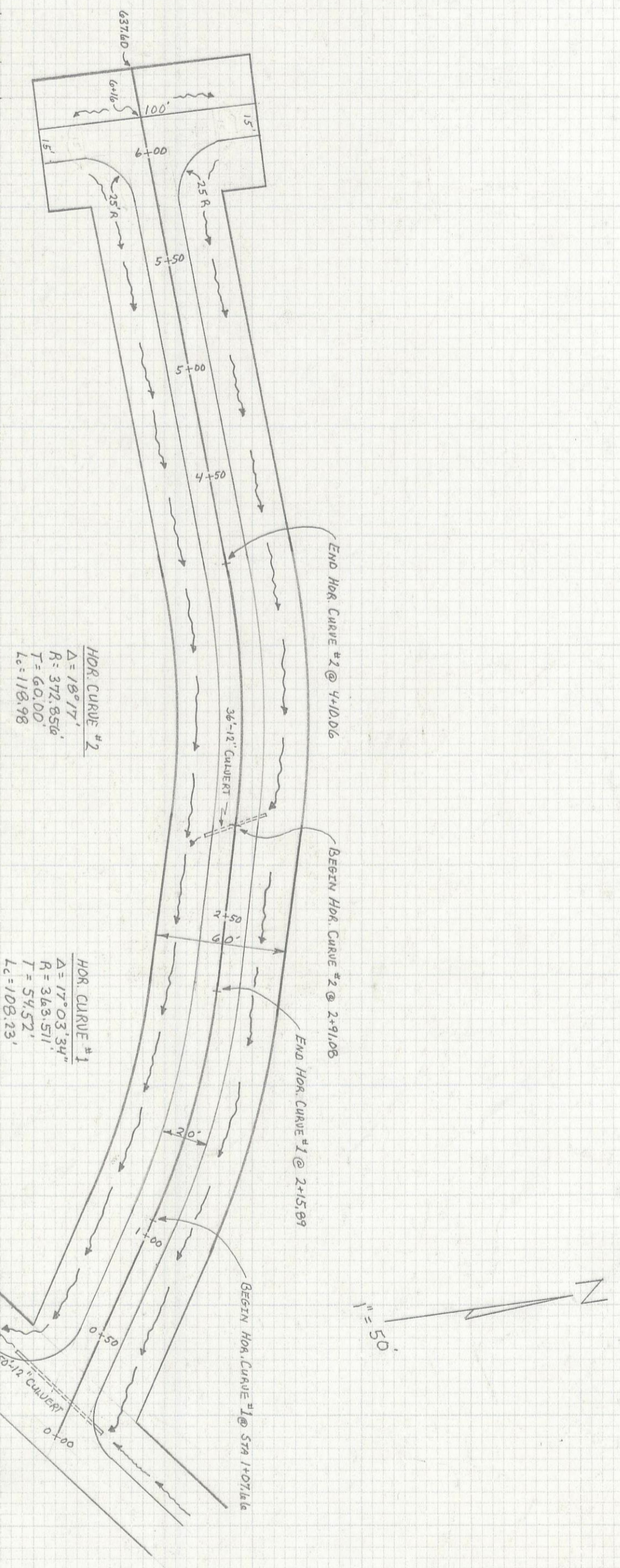
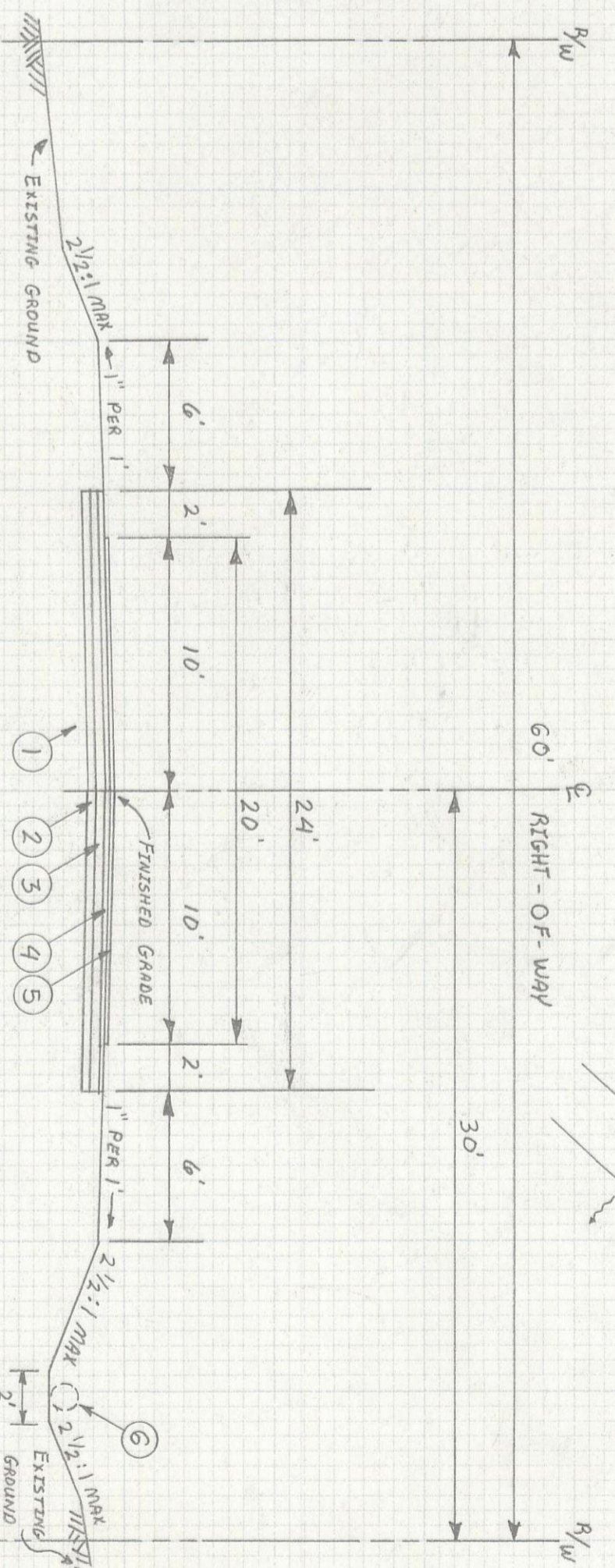

CERTIFIED BY: REGISTERED ENGINEER #43706
William R. Shaw

OWNER DEVELOPER: ROY BROWN JR.
10090 FRASURE HELBER RD.
LOGAN, OHIO 43138

HORIZONTAL SCALE: 1" = 50'
VERTICAL SCALE: 1" = 5'
DATE: MAY 14, 1979
SHEET NO. 1 OF 1

WHITE OAK ESTATES
ROAD PROFILE

SEYMOUR-SHAW AND ASSOCIATES, INC.
CONSULTING ENGINEERS SURVEYORS
615 WALHONDING AVENUE LOGAN, OHIO 43138
614 385-4349