

MARION, No. 15, Range 17, Section No. 11.

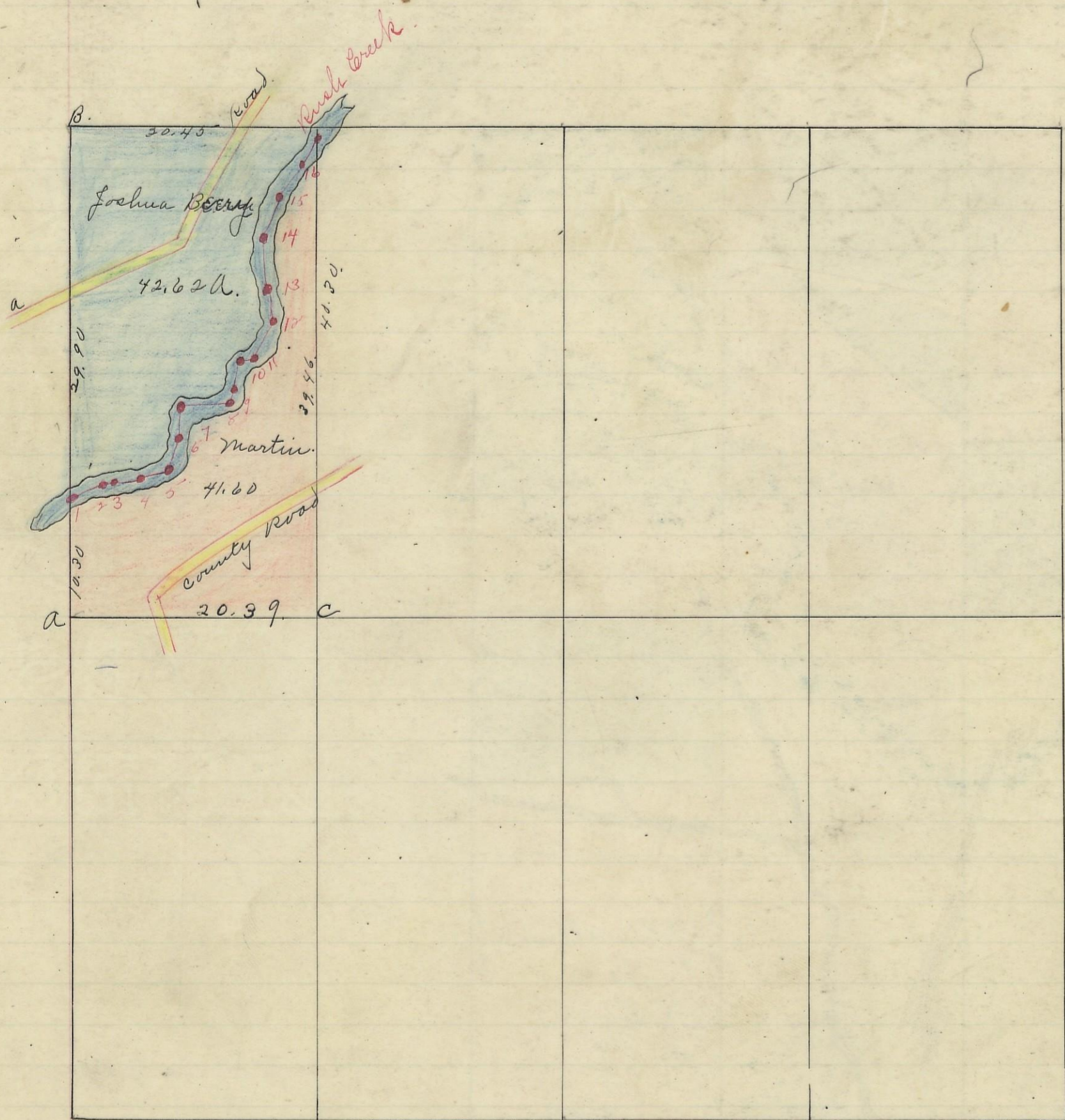

Variation
from A to B. 20 30' N.

" " A to C. 1 30' "

=====
of

o

o

o

o

o

o

o

o

o

o

o

o

o

o

o

o

o

o

o

o

o

Scale 10 chs to an inch

Numbers.

Joshua Beery. Lot- N ^o 1- 40.62 Acres	N ^o 1. N 36 E. 3.00	N ^o 2. N 60 1/2 E 1.29	N 3. N 78 E 2.27
Martin Lot- N ^o 2- 41.60	N ^o 4. N 72 E. 2.04	N ^o 5. N 49 E 2.93	N ^o 6. N 7 1/2 N 5.00
	N ^o 7. N 84 E. 4.50	N ^o 8. N 31 1/2 E 1.78	N ^o 9. 8 1/4 E 2.45
	N ^o 10. N 60 1/2 E 1.68	N ^o 11. N 45 E. 4.19	N ^o 12. N 2 1/2 E 2.31
	N ^o 13. N 18. N. 3.92	N ^o 14. N 8. E 2.14	N ^o 15. N 46 E 2.42
	N ^o 16. N 24. E 2.50		

I here by Certify the above to be a correct Plat of Fractional Lots in Section N^o 11. Township N^o 15 Range N^o 17. Jackson County, Ohio Surveyed June 1866. Recorded July 3rd 1866. By Levi Davis, S. C. W. Biram Ackers. Recorder. S. C. W.

I here by Certify the above to be a true Copy. P. D. Sloan Recorder S. C. W. The Above Plat transferred from Plat-Book A page 19. Record of fractional Lots. S. C. W. June 3rd 19th P. D. Sloan Recorder S. C. W.