

4-5-00

# HOCKING COUNTY

Sec. 21 T11 R18

BENTON TWP.

Scale: 1"=200'

21-A

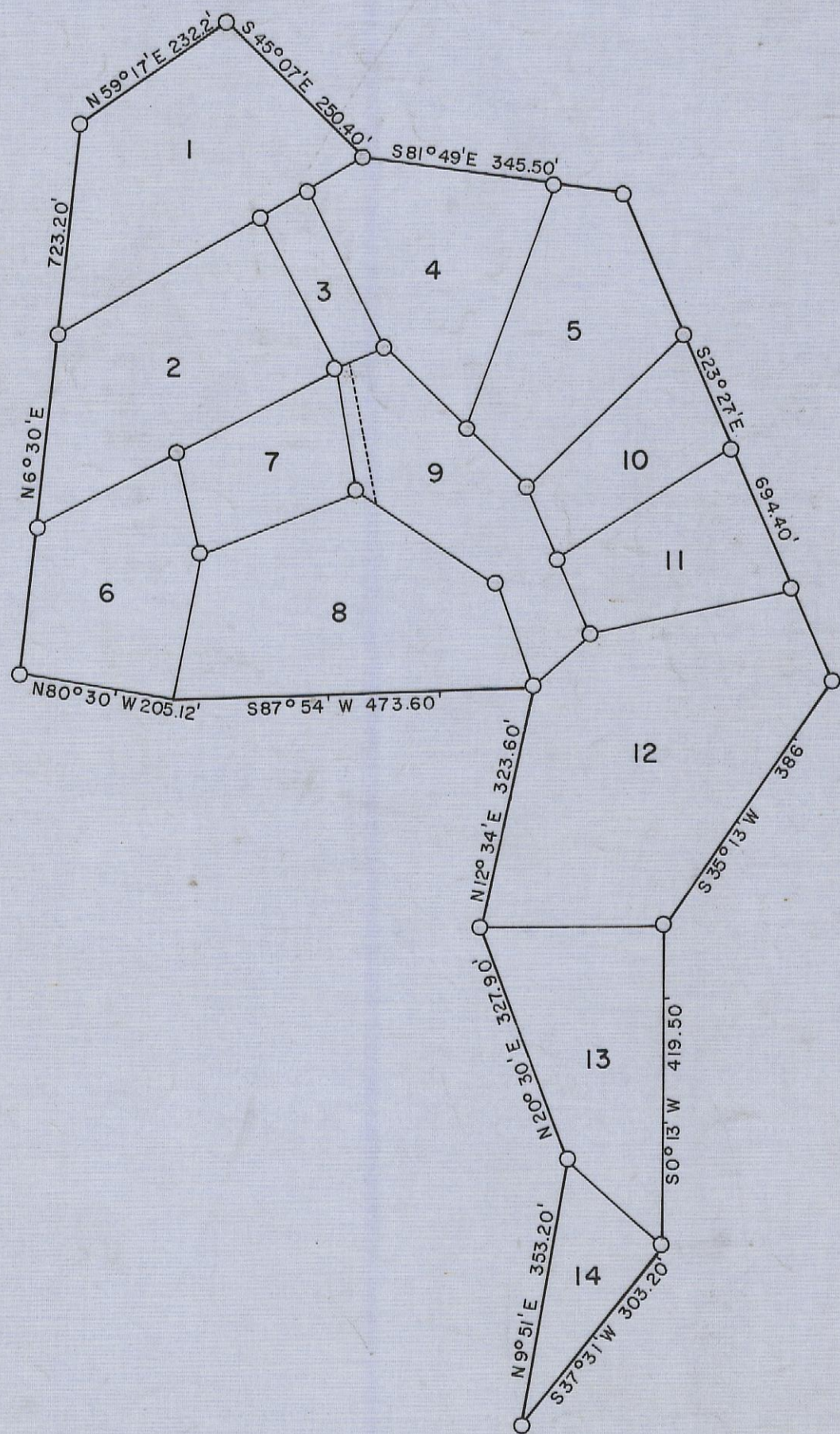
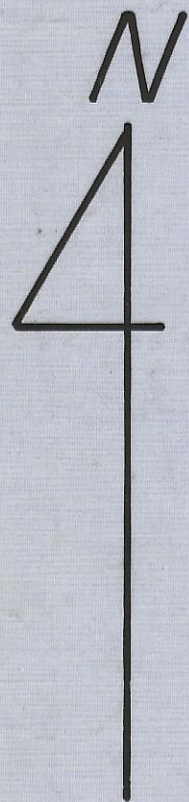

|        |                           |                                     |           |
|--------|---------------------------|-------------------------------------|-----------|
| Lot 1  | Charles Lantz             | OR5 - 605                           | 1.848 Ac. |
| Lot 2  | " "                       | " "                                 | 1.863 Ac. |
| Lot 3  | Rustic Hills Outdoor Club | 211 - 562                           | .37 Ac.   |
| Lot 4  | Roy Kean                  | 74-966, 206-738                     | 1.474 Ac. |
| Lot 5  | Roy Kean                  | OR74-966, 185-573                   | 1.445 Ac. |
| Lot 6  | John & Mary Sommer        | OR45-559, OR60-754, 755, 756, 1,227 | Ac.       |
| Lot 7  | John & Mary Sommer        | 206-248                             | .748 Ac.  |
| Lot 8  | John & Mary Sommer        | 218-535                             | 2.03 Ac.  |
| Lot 9  | Donna Szuhy               | 196-12                              | 1.245 Ac. |
| Lot 10 | Roy Kean                  | OR74-966, 206-738                   | .812 Ac.  |
| Lot 11 | " "                       | " "                                 | .966 Ac.  |
| Lot 12 | Willard & Mary Burmester  | 196-636                             | 2.99 Ac.  |
| Lot 13 | Edward & Eleanor Vetter   | 210-830                             | 1.455 Ac. |
| Lot 14 | " "                       | " "                                 | .57 Ac.   |

## RUSTIC HILLS NO. 1 21-A